

MAINTENANCE & CAPITAL RESERVES

DIVISION OF RESPONSIBILITIES

Uplands HOA (Capital Reserves & Maintenance)	Uplands HOA (Maintenance Only including payment responsibilities)	Individual PO Association / Homeowner (Capital Reserves & Maintenance)									
<ul style="list-style-type: none"> Landscaping services in all Uplands common areas (including removal or replacement of dead/dying plant material) Lighting in pedestrian areas and roadways Signage, street signage and monument signs North of Waterfront Street Dog waste stations Furniture in common areas Roads, travel lanes, drive aisles Parking areas including curb Common area sidewalks Irrigation systems Parking space striping and signage Retaining walls (not including wall at PO Section 1) Private water line to curb stop at each unit Private sanitary sewer lines to manhole serving each building Private storm sewer system up to point of connection of townhome building Underdrains connecting to roof drains/downspouts <div data-bbox="56 1381 552 1470" style="border: 1px solid black; padding: 5px; margin-top: 10px;"> <div style="background-color: #90EE90; width: 20px; height: 15px; display: inline-block;"></div> <u>Capital Reserves</u> Uplands HOA responsibility </div> <div data-bbox="56 1507 552 1579" style="border: 1px solid black; padding: 5px; margin-top: 10px;"> <div style="background-color: #8B4513; width: 20px; height: 15px; display: inline-block;"></div> NHOA responsibility </div>	<ul style="list-style-type: none"> Landscaping in LCE's* and GCE's* Snow removal Trash Common area electricity bills Water bills for irrigation and home consumption Mailbox painting 	<ul style="list-style-type: none"> Removal or replacement of dead/dying plant material in LCE's and GCE's All vertical construction (entire townhouse structure) GCE areas between driveway aprons Lead walks Mailbox replacement Driveways and driveway aprons <div data-bbox="1036 835 1534 1249" style="border: 1px solid black; padding: 5px; margin-top: 10px;"> <table border="1" style="width: 100%; text-align: center;"> <tr><td style="background-color: #FFD700;">III</td></tr> <tr><td style="background-color: #800080;">IV</td></tr> <tr><td style="background-color: #4169E1;">V</td></tr> <tr><td style="background-color: #FF69B4;">VI</td></tr> <tr><td style="background-color: #FFFF00;">VII</td></tr> <tr><td style="background-color: #ADD8E6;">VIII</td></tr> <tr><td style="background-color: #90EE90;">IX</td></tr> <tr><td style="background-color: #00CED1;">IX East</td></tr> <tr><td style="background-color: #A9A9A9;">X</td></tr> </table> <p style="text-align: center; margin-top: 10px;"><u>Capital Reserves</u> Association/ Homeowner responsibility</p> </div>	III	IV	V	VI	VII	VIII	IX	IX East	X
III											
IV											
V											
VI											
VII											
VIII											
IX											
IX East											
X											

*LCE: Limited Common Elements include those areas designated as such in the Declaration or on the Condominium Plat. Any areas designated as Limited Common Elements are reserved for the exclusive use of the Unit Owner(s) of the Unit(s) to which they are declared to be appurtenant.

*GCE: General Common Elements include all of the Common Elements except Limited Common Elements and include, without limitation, (a) alleyways and other common drive aisles or roadways, and (b) the components or installations of central services and utilities serving the General Common Elements or two (2) or more Units.

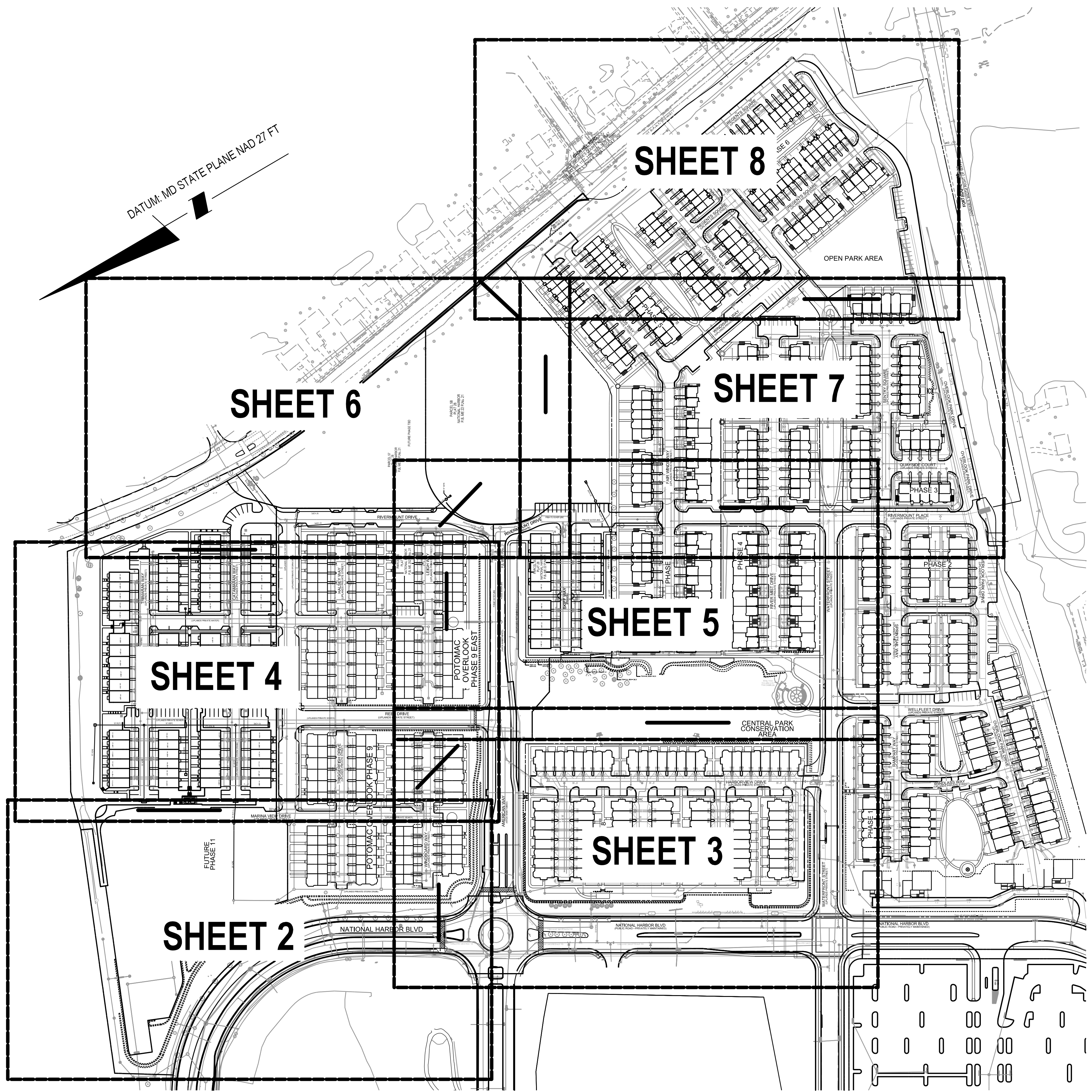

DATUM: MD STATE PLANE NAD 27 FT



The original of this drawing document was prepared by Soltesz, LLC (SOLTESZ). If this document was not obtained directly from SOLTESZ and/or it was transmitted electronically, SOLTESZ cannot guarantee that unauthorized changes and/or alterations were not made by others. A verification of the information contained herein is required. Contact should be made directly with SOLTESZ. SOLTESZ makes no warranty, express or implied, concerning the accuracy of any information that has been transmitted by electronic means.

SOLTESZ, LLC
 Engineering Surveying Planning Environmental Sciences
 4300 Forbes Boulevard, Suite 230
 Lanham, MD 20706
 P. 301.794.7555 F. 301.794.7656 www.soltesz.com

NO.	REVISIONS	BY	DATE

DATE: _____ CAD STANDARDS VERSION: V8 - 2000
 DESIGNED: _____ TECHNICIAN: _____ CHECKED: _____

MISS UTILITY NOTE
 INFORMATION CONCERNING EXISTING UNDERGROUND UTILITIES WAS OBTAINED FROM AVAILABLE RECORDS. THE CONTRACTOR MUST DETERMINE THE EXACT LOCATION AND ELEVATION OF ALL EXISTING UTILITIES AND UTILITY CROSSINGS BY DIGGING TEST PITS BY HAND, WELL IN ADVANCE OF THE START OF EXCAVATION. CONTACT "MISS UTILITY" AT 1-800-257-7777, 48 HOURS PRIOR TO THE START OF EXCAVATION. IF CLEARANCES ARE LESS THAN SHOWN ON THIS PLAN OR TWELVE (12) INCHES, WHICHEVER IS LESS, CONTACT THE ENGINEER AND THE UTILITY COMPANY BEFORE PROCEEDING WITH CONSTRUCTION. CLEARANCES LESS THAN NOTED MAY REQUIRE REVISIONS TO THIS PLAN.

OWNER/DEVELOPER/APPLICANT
 NATIONAL HARBOR WATERFRONT LC
 12500 FAIR LAKES CIRCLE
 FAIRFAX, VA 22033
 PHONE: 301-749-6700
 CONTACT: RON WAGNER
 RWAGNER@PETERSONCOS.COM

MAP 5764	GRID J5
TAX MAP 104 E4	ZONING CATEGORY: R-M R-R
WSSC 200' SHEET 210 SW 01 210 SE 01	
SITE DATUM HORIZONTAL: NAD27 VERTICAL: NSVD28	

PROFESSIONAL CERTIFICATION
 I HEREBY CERTIFY THAT THESE DOCUMENTS WERE PREPARED OR APPROVED BY ME, AND THAT I AM A DULY LICENSED PROFESSIONAL ENGINEER UNDER THE LAWS OF THE STATE OF MARYLAND.
 LICENSE NO. _____ EXPIRATION DATE: _____

SHEET OVERVIEW

**UPLANDS PHASE 3-11
 POTOMAC OVERLOOK**

FORT WASHINGTON (12th) ELECTION DISTRICT, PRINCE GEORGE'S COUNTY, MARYLAND

1" = 120'

SHEET **1** OF **8**

PROJECT NO. 1006-00-0V

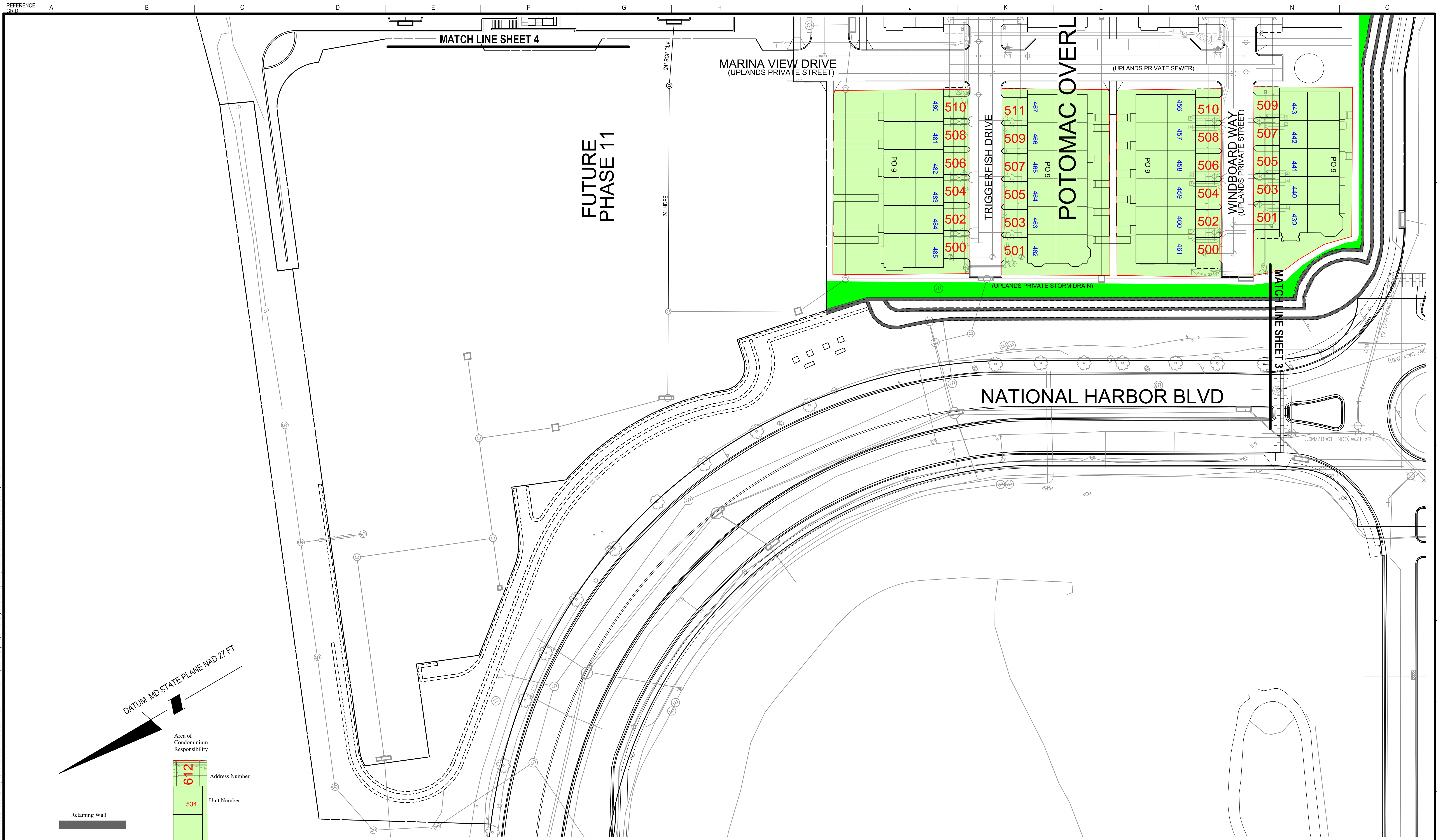

The original of this drawing document was prepared by Soltesz, LLC (SOLTESZ). If this document was not obtained directly from SOLTESZ and/or it was transmitted electronically, SOLTESZ cannot guarantee that unauthorized changes and/or alterations were not made by others. A verification of the information contained herein is needed. Contact should be made directly with SOLTESZ. SOLTESZ makes no warranty, express or implied, concerning the accuracy of any information that has been transmitted by electronic means.

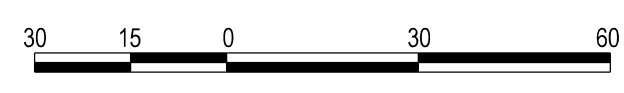
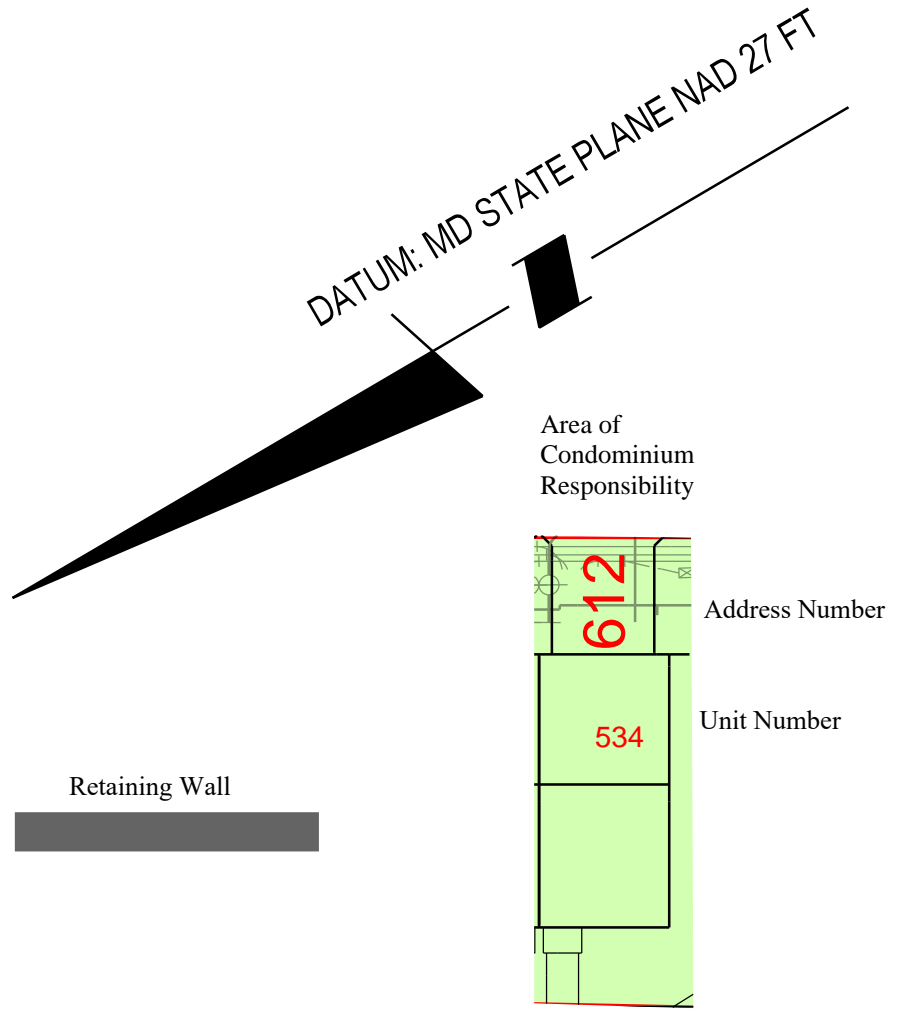

SOLTESZ, LLC

Engineering
Surveying
Planning
Environmental Sciences

4300 Forbes Boulevard, Suite 230
Lanham, MD 20706
P. 301.794.7555 F. 301.794.7656
www.solteszco.com

NO.	REVISIONS	BY	DATE

DATE: _____ CAD STANDARDS VERSION: V8 - 2000
DESIGNED: _____ TECHNICIAN: _____ CHECKED: _____

MISS UTILITY NOTE

INFORMATION CONCERNING EXISTING UNDERGROUND UTILITIES WAS OBTAINED FROM AVAILABLE RECORDS. THE CONTRACTOR MUST DETERMINE THE EXACT LOCATION AND ELEVATION OF ALL EXISTING UTILITIES AND UTILITY CROSSINGS BY DIGGING TEST PITS BY HAND, WELL IN ADVANCE OF THE START OF EXCAVATION. CONTACT "MISS UTILITY" AT 1-800-257-7777, 48 HOURS PRIOR TO THE START OF EXCAVATION. IF CLEARANCES ARE LESS THAN SHOWN ON THIS PLAN OR TWELVE (12) INCHES, WHICHEVER IS LESS, CONTACT THE ENGINEER AND THE UTILITY COMPANY BEFORE PROCEEDING WITH CONSTRUCTION. CLEARANCES LESS THAN NOTED MAY REQUIRE REVISIONS TO THIS PLAN.

OWNER/DEVELOPER/APPLICANT

NATIONAL HARBOR WATERFRONT LC
12500 FAIR LAKES CIRCLE
FAIRFAX, VA 22033
PHONE: 301-749-6700
CONTACT: RON WAGNER
RWAGNER@PETERSONCOS.COM

MAP 5764	GRID J5
TAX MAP 104 E4	ZONING CATEGORY: R-M R-R
WSSC 200' SHEET 210 SW 01	210 SE 01
SITE DATUM HORIZONTAL: NAD27	VERTICAL: NGVD29

PROFESSIONAL CERTIFICATION

I HEREBY CERTIFY THAT THESE DOCUMENTS WERE PREPARED OR APPROVED BY ME, AND THAT I AM A DULY LICENSED PROFESSIONAL ENGINEER UNDER THE LAWS OF THE STATE OF MARYLAND.

LICENSE NO. _____ EXPIRATION DATE: _____

PLAN VIEW

**UPLANDS PHASE 3-11
POTOMAC OVERLOOK**

FORT WASHINGTON (12th) ELECTION DISTRICT, PRINCE GEORGE'S COUNTY, MARYLAND

1" = 30'

SHEET **2**
OF **8**

PROJECT NO.
1006-00-0V

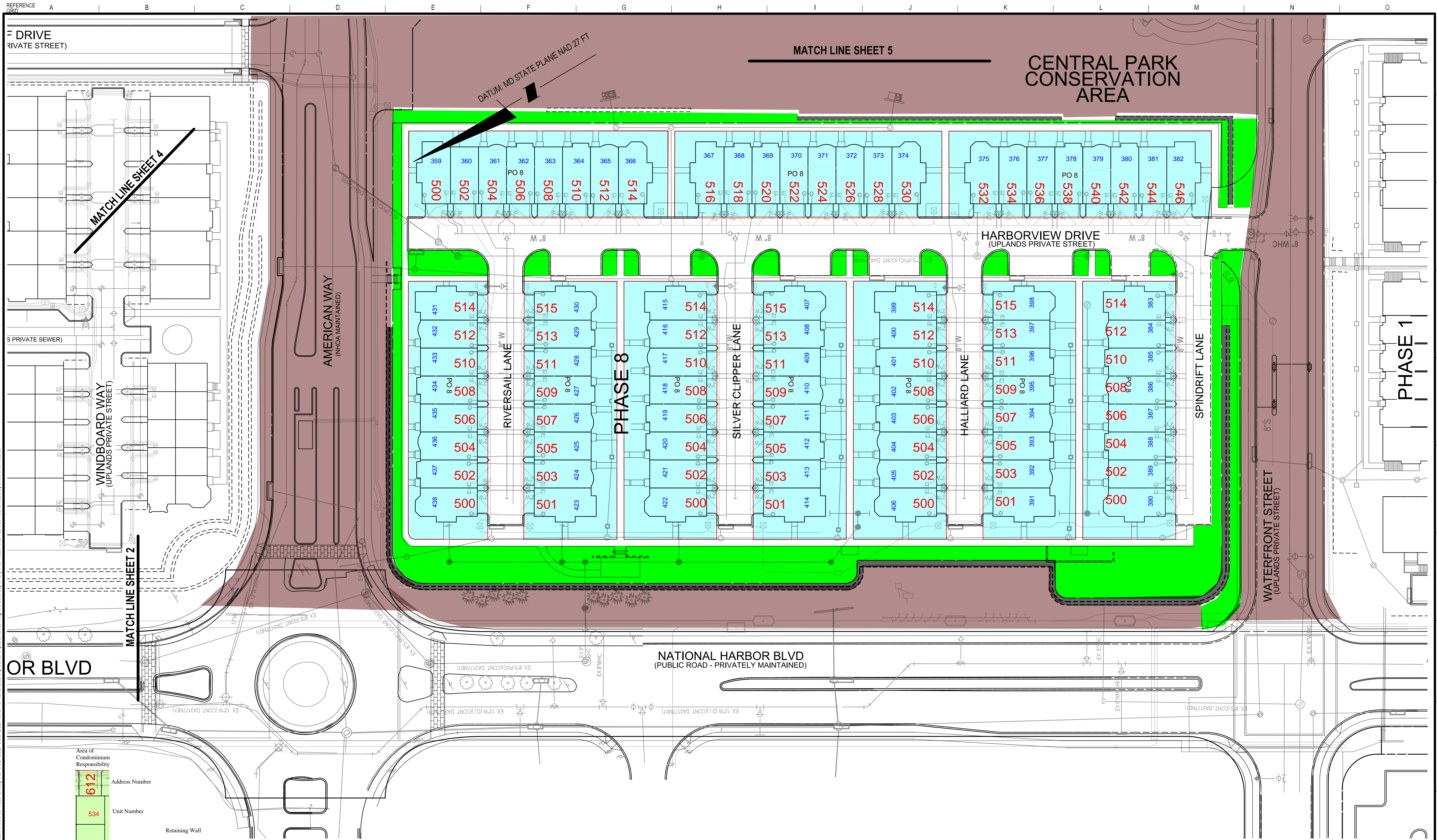

The original of this drawing document was prepared by Soltesz, LLC (SOLTESZ). If this document was not obtained directly from SOLTESZ and/or it was transmitted electronically, SOLTESZ cannot guarantee that unauthorized changes and/or alterations were not made by others. A verification of the information contained herein is required. Contact should be made directly with SOLTESZ. SOLTESZ makes no warranty, express or implied, concerning the accuracy of any information that has been transmitted by electronic means.

SOLTESZ, LLC

Engineering
Surveying
Planning
Environmental Sciences

4300 Forbes Boulevard, Suite 230
Lanham, MD 20706
P. 301.794.7555 F. 301.794.7656 www.solteszco.com

NO.	REVISIONS	BY	DATE

DATE: _____ CAD STANDARDS VERSION: V8 - 2000
DESIGNED: _____ TECHNICIAN: _____ CHECKED: _____

MISS UTILITY NOTE

INFORMATION CONCERNING EXISTING UNDERGROUND UTILITIES WAS OBTAINED FROM AVAILABLE RECORDS. THE CONTRACTOR MUST DETERMINE THE EXACT LOCATION AND ELEVATION OF ALL EXISTING UTILITIES AND UTILITY CROSSINGS BY DIGGING TEST PITS BY HAND, WELL IN ADVANCE OF THE START OF EXCAVATION. CONTACT "MISS UTILITY" AT 1-800-251-7777, 48 HOURS PRIOR TO THE START OF EXCAVATION. IF CLEARANCES ARE LESS THAN SHOWN ON THIS PLAN OR TWELVE (12) INCHES, WHICHEVER IS LESS, CONTACT THE ENGINEER AND THE UTILITY COMPANY BEFORE PROCEEDING WITH CONSTRUCTION. CLEARANCES LESS THAN NOTED MAY REQUIRE REVISIONS TO THIS PLAN.

OWNER/DEVELOPER/APPLICANT

NATIONAL HARBOR WATERFRONT LC
12500 FAIR LAKES CIRCLE
FAIRFAX, VA 22033
PHONE: 301-749-6700
CONTACT: RON WAGNER
RWAGNER@PETERSONCOS.COM

MAP 5764 GRID J5

TAX MAP 104 E4	ZONING CATEGORY: R-M R-R
WSSC 200' SHEET 210 SW 01 210 SE 01	
SITE DATUM HORIZONTAL: NAD27 VERTICAL: NGVD29	

PROFESSIONAL CERTIFICATION

I HEREBY CERTIFY THAT THESE DOCUMENTS WERE PREPARED OR APPROVED BY ME, AND THAT I AM A DULY LICENSED PROFESSIONAL ENGINEER UNDER THE LAWS OF THE STATE OF MARYLAND.
LICENSE NO. _____ EXPIRATION DATE: _____

PLAN VIEW

**UPLANDS PHASE 3-11
POTOMAC OVERLOOK**

FORT WASHINGTON (12th) ELECTION DISTRICT, PRINCE GEORGE'S COUNTY, MARYLAND

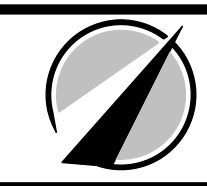

1" = 30'

SHEET **3**
OF **8**

PROJECT NO.
1006-00-0V

The original of this drawing document was prepared by Soltesz, LLC (SOLTESZ). If this document was not obtained directly from SOLTESZ and/or it was transmitted electronically, SOLTESZ cannot guarantee that unauthorized changes and/or alterations were not made by others. A verification of the information contained herein is required. Contact should be made directly with SOLTESZ. SOLTESZ makes no warranty, express or implied, concerning the accuracy of any information that has been transmitted by electronic means.

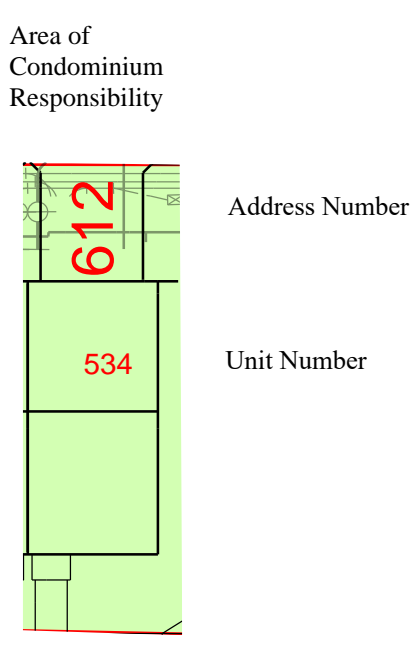

PROFESSIONAL CERTIFICATION
 I HEREBY CERTIFY THAT THESE DOCUMENTS WERE PREPARED OR APPROVED BY ME, AND THAT I AM A DULY LICENSED PROFESSIONAL ENGINEER UNDER THE LAWS OF THE STATE OF MARYLAND.
 LICENSE NO. _____ EXPIRATION DATE: _____

PLAN VIEW

**UPLANDS PHASE 3-11
 POTOMAC OVERLOOK**

FORT WASHINGTON (12th) ELECTION DISTRICT, PRINCE GEORGE'S COUNTY, MARYLAND

SOLTESZ, LLC

Engineering
 Surveying
 Planning
 Environmental Sciences

4300 Forbes Boulevard, Suite 230
 Lanham, MD 20706
 P. 301.794.7555 F. 301.794.7656 www.solteszco.com

NO.	REVISIONS	BY	DATE

DATE: _____ CAD STANDARDS VERSION: V8 - 2000
 DESIGNED: _____ TECHNICIAN: _____ CHECKED: _____

MISS UTILITY NOTE
 INFORMATION CONCERNING EXISTING UNDERGROUND UTILITIES WAS OBTAINED FROM AVAILABLE RECORDS. THE CONTRACTOR MUST DETERMINE THE EXACT LOCATION AND ELEVATION OF ALL EXISTING UTILITIES AND UTILITY CROSSINGS BY DIGGING TEST PITS BY HAND, WELL IN ADVANCE OF THE START OF EXCAVATION. CONTACT "MISS UTILITY" AT 1-800-257-7777, 48 HOURS PRIOR TO THE START OF EXCAVATION. IF CLEARANCES ARE LESS THAN SHOWN ON THIS PLAN OR TWELVE (12) INCHES, WHICHEVER IS LESS, CONTACT THE ENGINEER AND THE UTILITY COMPANY BEFORE PROCEEDING WITH CONSTRUCTION. CLEARANCES LESS THAN NOTED MAY REQUIRE REVISIONS TO THIS PLAN.

OWNER/DEVELOPER/APPLICANT
 NATIONAL HARBOR WATERFRONT LC
 12500 FAIR LAKES CIRCLE
 FAIRFAX, VA 22033
 PHONE: 301-749-6700
 CONTACT: RON WAGNER
 RWAGNER@PETERSONCOS.COM

MAP 5764	GRID J5
TAX MAP 104 E4	ZONING CATEGORY: R-M R-R
WSSC 200' SHEET 210 SW 01 210 SE 01	SITE DATUM HORIZONTAL: NAD27 VERTICAL: NGVD 29

PLAN VIEW

1" = 30'

SHEET **4**
 OF **8**

PROJECT NO.
 1006-00-0V

The original of this drawing document was prepared by Soltesz, LLC (SOLTESZ). If this document was not obtained directly from SOLTESZ and/or it was transmitted electronically, SOLTESZ cannot guarantee the accuracy of any information that has been transmitted by electronic means. A verification of the information contained herein is required. Contact should be made directly with SOLTESZ. SOLTESZ makes no warranty, express or implied, concerning the accuracy of any information that has been transmitted by electronic means.

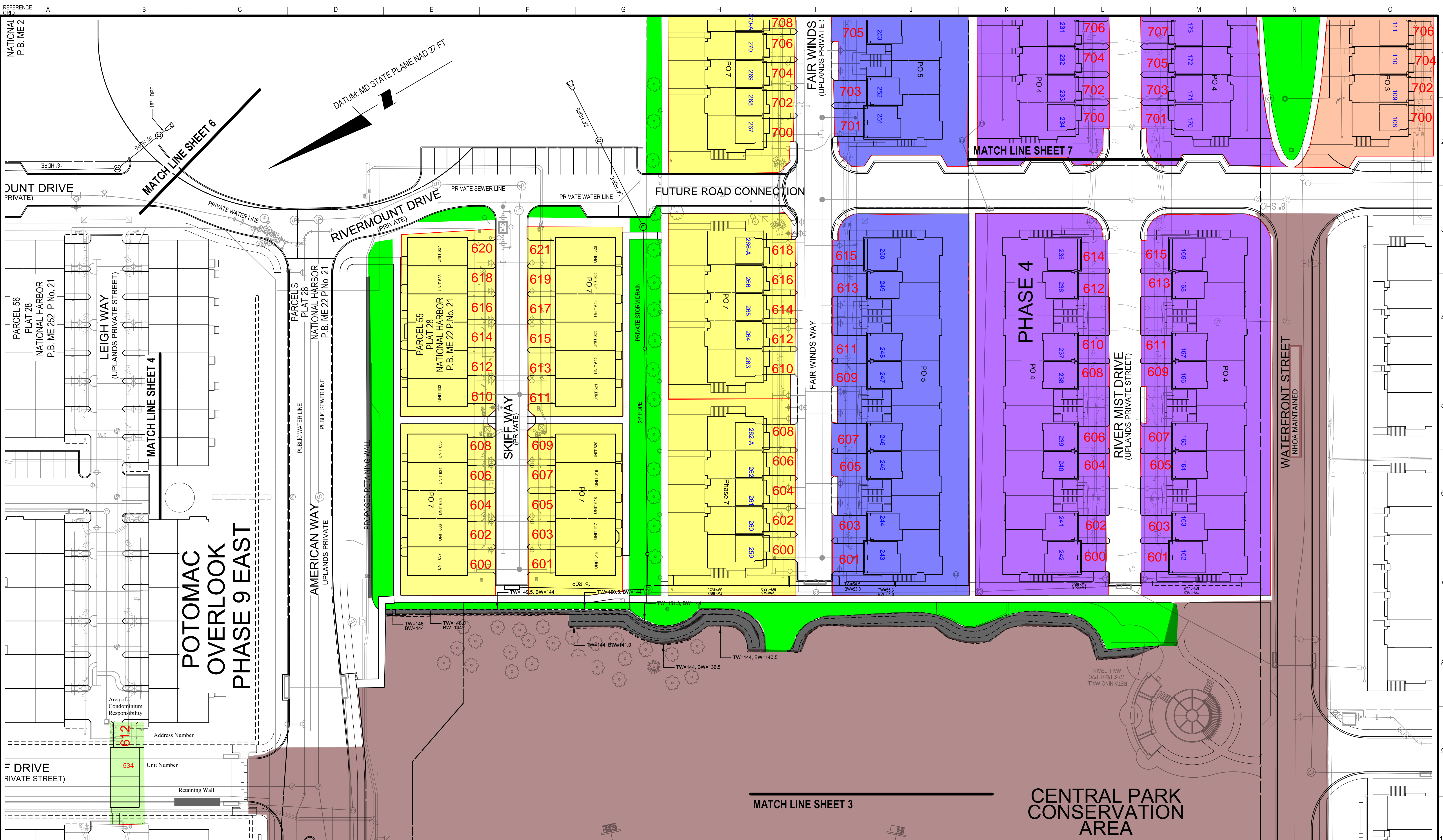

POTOMAC OVERLOOK PHASE 9 EAST

Area of Condominium Responsibility

Address Number

Unit Number

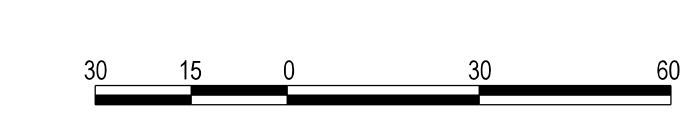

SOLTESZ, LLC

Engineering
Surveying
Planning
Environmental Sciences

4300 Forbes Boulevard, Suite 230
Lanham, MD 20706
P. 301.794.7555 F. 301.794.7656
www.solteszco.com

NO.	REVISIONS	BY	DATE

DATE: _____ CAD STANDARDS VERSION: V8 - 2000
DESIGNED: _____ TECHNICIAN: _____ CHECKED: _____

MISS UTILITY NOTE

INFORMATION CONCERNING EXISTING UNDERGROUND UTILITIES WAS OBTAINED FROM AVAILABLE RECORDS. THE CONTRACTOR MUST DETERMINE THE EXACT LOCATION AND ELEVATION OF ALL EXISTING UTILITIES AND UTILITY CROSSINGS BY DIGGING TEST PITS BY HAND, WELL IN ADVANCE OF THE START OF EXCAVATION. CONTACT "MISS UTILITY" AT 1-800-251-7777, 48 HOURS PRIOR TO THE START OF EXCAVATION. IF CLEARANCES ARE LESS THAN SHOWN ON THIS PLAN OR TWELVE (12) INCHES, WHICHEVER IS LESS, CONTACT THE ENGINEER AND THE UTILITY COMPANY BEFORE PROCEEDING WITH CONSTRUCTION. CLEARANCES LESS THAN NOTED MAY REQUIRE REVISIONS TO THIS PLAN.

OWNER/DEVELOPER/APPLICANT

NATIONAL HARBOR WATERFRONT LC
12500 FAIR LAKES CIRCLE
FAIRFAX, VA 22033
PHONE: 301-749-6700
CONTACT: RON WAGNER
RWAGNER@PETERSONCOS.COM

MAP 5764	GRID J5
TAX MAP 104 E4	ZONING CATEGORY: R-M R-R
WSSC 200' SHEET 210 SW 01	210 SE 01
SITE DATUM HORIZONTAL: NAD27	VERTICAL: NGVD 29

PROFESSIONAL CERTIFICATION

I HEREBY CERTIFY THAT THESE DOCUMENTS WERE PREPARED OR APPROVED BY ME, AND THAT I AM A DULY LICENSED PROFESSIONAL ENGINEER UNDER THE LAWS OF THE STATE OF MARYLAND.

LICENSE NO. _____ EXPIRATION DATE: _____

PLAN VIEW

**UPLANDS PHASE 3-11
POTOMAC OVERLOOK**

FORT WASHINGTON (12th) ELECTION DISTRICT, PRINCE GEORGE'S COUNTY, MARYLAND

SHEET **5** OF **8**

PROJECT NO. 1006-00-0V

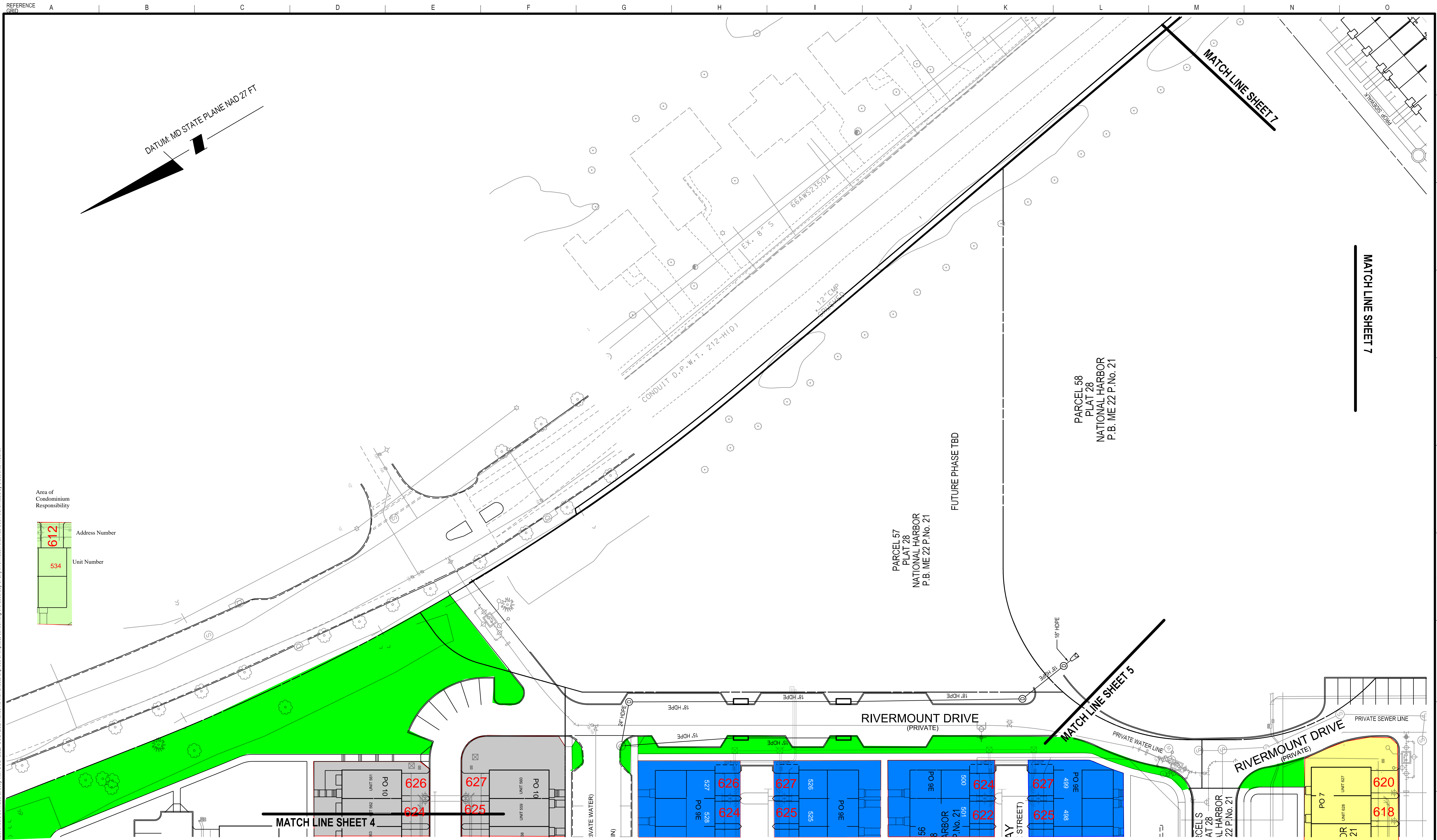

DATUM: MD STATE PLANE NAD 27 FT

MATCH LINE SHEET 7

MATCH LINE SHEET 7

PARCEL 58
PLAT 28
NATIONAL HARBOR
P.B. ME 22 P.No. 21

PARCEL 57
PLAT 28
NATIONAL HARBOR
P.B. ME 22 P.No. 21

FUTURE PHASE TBD

RIVERMOUNT DRIVE
(PRIVATE)

RIVERMOUNT DRIVE
(PRIVATE)

MATCH LINE SHEET 4

MATCH LINE SHEET 5

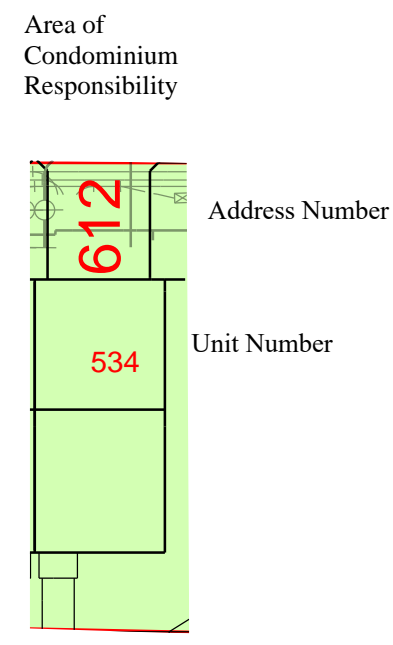

PROFESSIONAL CERTIFICATION
I HEREBY CERTIFY THAT THESE DOCUMENTS WERE PREPARED OR APPROVED BY ME, AND THAT I AM A DULY LICENSED PROFESSIONAL ENGINEER UNDER THE LAWS OF THE STATE OF MARYLAND.
LICENSE NO. _____ EXPIRATION DATE: _____

PLAN VIEW

**UPLANDS PHASE 3-11
POTOMAC OVERLOOK**

FORT WASHINGTON (12th) ELECTION DISTRICT, PRINCE GEORGE'S COUNTY, MARYLAND

SOLTESZ, LLC
Engineering
Surveying
Planning
Environmental Sciences
4300 Forbes Boulevard, Suite 230
Lanham, MD 20706
P. 301.794.7555 F. 301.794.7656
www.solteszco.com

NO.	REVISIONS	BY	DATE

DATE: _____ CAD STANDARDS VERSION: V8 - 2000
DESIGNED: _____ TECHNICIAN: _____ CHECKED: _____

MISS UTILITY NOTE
INFORMATION CONCERNING EXISTING UNDERGROUND UTILITIES WAS OBTAINED FROM AVAILABLE RECORDS. THE CONTRACTOR MUST DETERMINE THE EXACT LOCATION AND ELEVATION OF ALL EXISTING UTILITIES AND UTILITY CROSSINGS BY DIGGING TEST PITS BY HAND, WELL IN ADVANCE OF THE START OF EXCAVATION. CONTACT "MISS UTILITY" AT 1-800-257-7777, 48 HOURS PRIOR TO THE START OF EXCAVATION. IF CLEARANCES ARE LESS THAN SHOWN ON THIS PLAN OR TWELVE (12) INCHES, WHICHEVER IS LESS, CONTACT THE ENGINEER AND THE UTILITY COMPANY BEFORE PROCEEDING WITH CONSTRUCTION. CLEARANCES LESS THAN NOTED MAY REQUIRE REVISIONS TO THIS PLAN.

OWNER/DEVELOPER/APPLICANT
NATIONAL HARBOR WATERFRONT LC
12500 FAIR LAKES CIRCLE
FAIRFAX, VA 22033
PHONE: 301-749-6700
CONTACT: RON WAGNER
RWAGNER@PETERSONCOS.COM

MAP 5764	GRID J5
TAX MAP 104 E4	ZONING CATEGORY: R-M R-R
WSSC 200' SHEET 210 SW 01 210 SE 01	
SITE DATUM HORIZONTAL: NAD27 VERTICAL: NGVD 28	

1" = 30'

SHEET 6 OF 8

PROJECT NO. 1006-00-0V

The original of this drawing document was prepared by Soltesz, LLC (SOLTESZ). If this document was not obtained directly from SOLTESZ and/or it was transmitted electronically, SOLTESZ cannot guarantee that unauthorized changes and/or alterations were not made by others. A verification of the information contained herein is required. Contact should be made directly with SOLTESZ. SOLTESZ makes no warranty, express or implied, concerning the accuracy of any information that has been transmitted by electronic means.

The original of this drawing document was prepared by Soltesz, LLC (SOLTESZ). If this document was not obtained directly from SOLTESZ and/or it was transmitted electronically, SOLTESZ cannot guarantee that unauthorized changes and/or alterations were not made by others. A verification of the information contained herein is required. Contact should be made directly with SOLTESZ. SOLTESZ makes no warranty, express or implied, concerning the accuracy of any information that has been transmitted by electronic means.

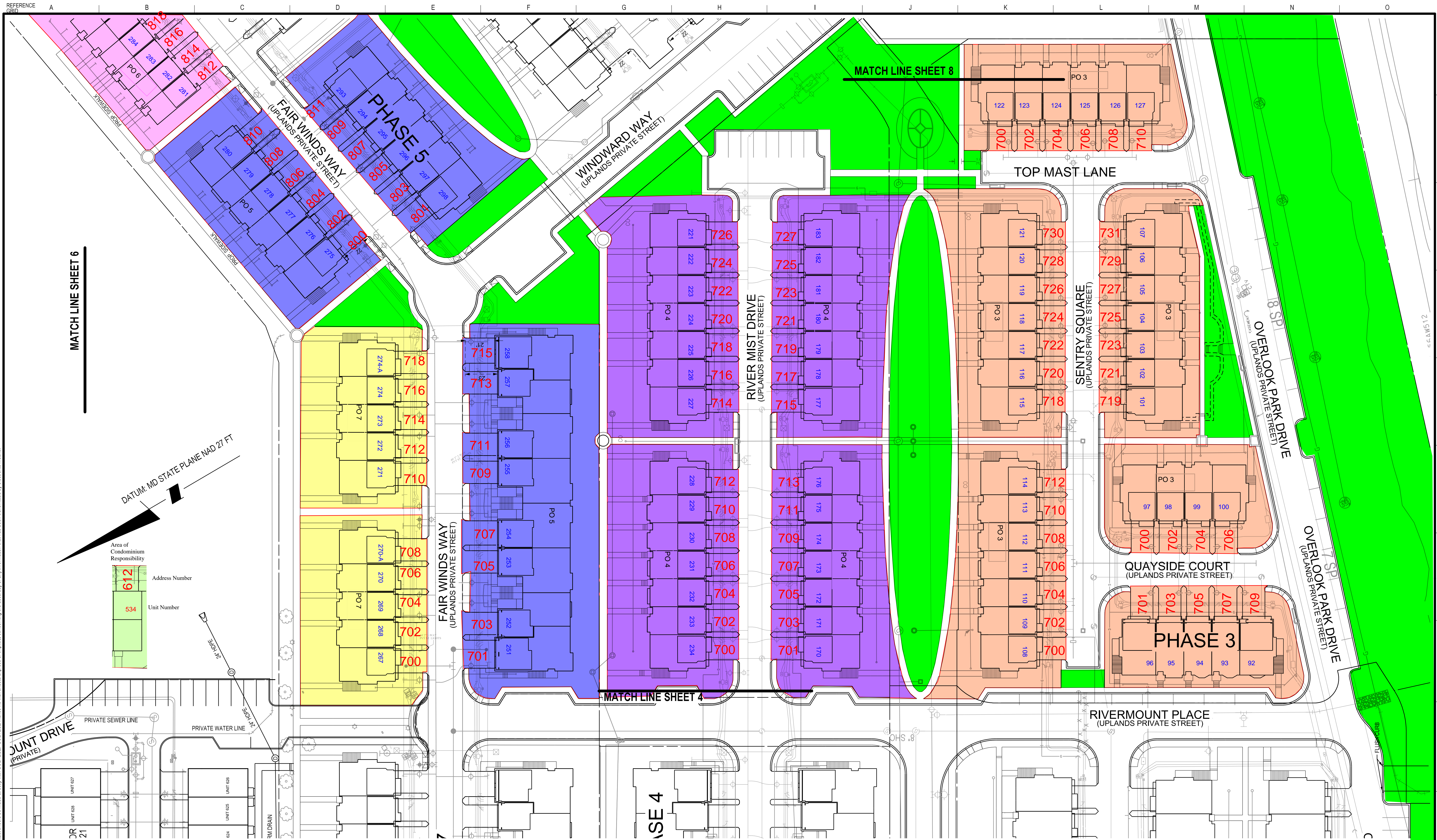

SOLTESZ, LLC
 Engineering
 Surveying
 Planning
 Environmental Sciences
 4300 Forbes Boulevard, Suite 230
 Lanham, MD 20706
 P. 301.794.7555 F. 301.794.7656
 www.solteszco.com

NO.	REVISIONS	BY	DATE

DATE: _____ CAD STANDARDS VERSION: V8 - 2000
 DESIGNED: _____ TECHNICIAN: _____ CHECKED: _____

MISS UTILITY NOTE
 INFORMATION CONCERNING EXISTING UNDERGROUND UTILITIES WAS OBTAINED FROM AVAILABLE RECORDS. THE CONTRACTOR MUST DETERMINE THE EXACT LOCATION AND ELEVATION OF ALL EXISTING UTILITIES AND UTILITY CROSSINGS BY DIGGING TEST PITS BY HAND, WELL IN ADVANCE OF THE START OF EXCAVATION. CONTACT "MISS UTILITY" AT 1-800-251-7777, 48 HOURS PRIOR TO THE START OF EXCAVATION. IF CLEARANCES ARE LESS THAN SHOWN ON THIS PLAN OR TWELVE (12) INCHES, WHICHEVER IS LESS, CONTACT THE ENGINEER AND THE UTILITY COMPANY BEFORE PROCEEDING WITH CONSTRUCTION. CLEARANCES LESS THAN NOTED MAY REQUIRE REVISIONS TO THIS PLAN.

OWNER/DEVELOPER/APPLICANT
 NATIONAL HARBOR WATERFRONT LC
 12500 FAIR LAKES CIRCLE
 FAIRFAX, VA 22033
 PHONE: 301-749-6700
 CONTACT: RON WAGNER
 RWAGNER@PETERSONCOS.COM

MAP 5764	GRID J5
TAX MAP 104 E4	ZONING CATEGORY: R-M R-R
WSSC 200' SHEET 210 SW 01 210 SE 01	SITE DATUM HORIZONTAL: NAD27 VERTICAL: NGVD 29

PROFESSIONAL CERTIFICATION
 I HEREBY CERTIFY THAT THESE DOCUMENTS WERE PREPARED OR APPROVED BY ME, AND THAT I AM A DULY LICENSED PROFESSIONAL ENGINEER UNDER THE LAWS OF THE STATE OF MARYLAND.
 LICENSE NO. _____ EXPIRATION DATE: _____

PLAN VIEW

**UPLANDS PHASE 3-11
 POTOMAC OVERLOOK**

FORT WASHINGTON (12th) ELECTION DISTRICT, PRINCE GEORGE'S COUNTY, MARYLAND

 1" = 30' SHEET 7 OF 8 PROJECT NO. 1006-00-0V
--

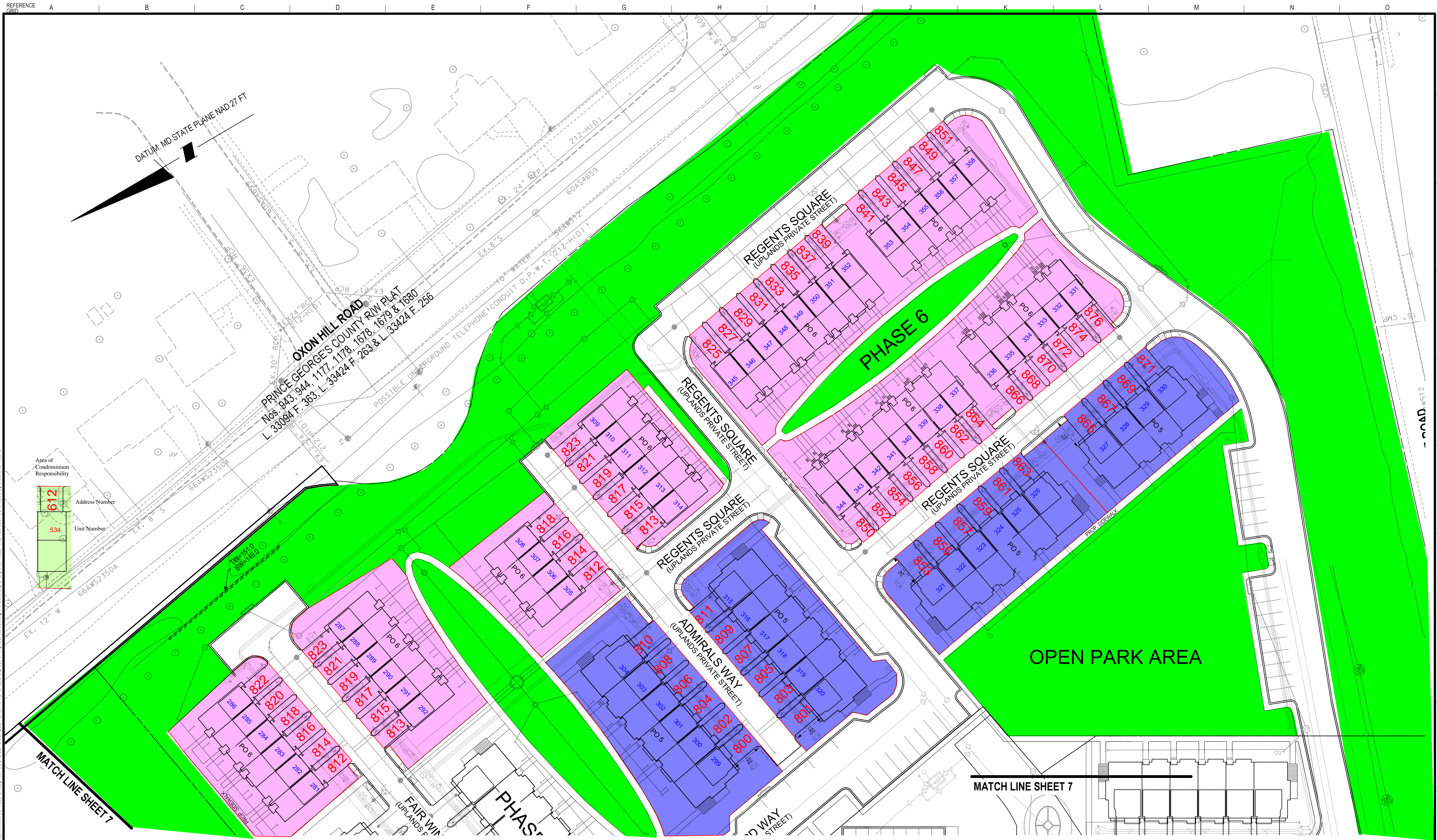

The original of this drawing document was prepared by Soltesz, LLC (SOLTESZ). If this document was not obtained directly from SOLTESZ, LLC, it was transmitted electronically. SOLTESZ, LLC cannot guarantee the accuracy of any information that has been transmitted by electronic means. A verification of the information contained herein is required. Contact should be made directly with SOLTESZ, LLC. SOLTESZ makes no warranty, express or implied, concerning the accuracy of any information that has been transmitted by electronic means.

SOLTESZ, LLC
 Engineering
 Surveying
 Planning
 Environmental Sciences

4300 Forbes Boulevard, Suite 230
 Lanham, MD 20706
 P. 301.794.7555 F. 301.794.7656 www.solteszco.com

NO.	DATE	REVISIONS	BY	DATE

CAD STANDARDS VERSION: V8 - 2000

DESIGNED: _____ TECHNICIAN: _____ CHECKED: _____

MISS UTILITY NOTE
 INFORMATION CONCERNING EXISTING UNDERGROUND UTILITIES WAS OBTAINED FROM AVAILABLE RECORDS. THE CONTRACTOR MUST DETERMINE THE EXACT LOCATION AND ELEVATION OF ALL EXISTING UTILITIES AND UTILITY CROSSINGS BY DIGGING TEST PITS BY HAND, WELL IN ADVANCE OF THE START OF EXCAVATION. CONTACT "MISS UTILITY" AT 1-800-251-7777, 48 HOURS PRIOR TO THE START OF EXCAVATION. IF CLEARANCES ARE LESS THAN SHOWN ON THIS PLAN OR TWELVE (12) INCHES, WHICHEVER IS LESS, CONTACT THE ENGINEER AND THE UTILITY COMPANY BEFORE PROCEEDING WITH CONSTRUCTION. CLEARANCES LESS THAN NOTED MAY REQUIRE REVISIONS TO THIS PLAN.

OWNER/DEVELOPER/APPLICANT
 NATIONAL HARBOR WATERFRONT LC
 12500 FAIR LAKES CIRCLE
 FAIRFAX, VA 22033
 PHONE: 301-749-6700
 CONTACT: RON WAGNER
 RWAGNER@PETERSONCOS.COM

MAP: 5764	GRID: J5
TAX MAP: 104 E4	ZONING CATEGORY: R-M R-R
WSSC 200' SHEET: 210 SW 01, 210 SE 01	
SITE DATUM: HORIZONTAL: NAD27, VERTICAL: NGVD 29	

PROFESSIONAL CERTIFICATION
 I HEREBY CERTIFY THAT THESE DOCUMENTS WERE PREPARED OR APPROVED BY ME, AND THAT I AM A DULY LICENSED PROFESSIONAL ENGINEER UNDER THE LAWS OF THE STATE OF MARYLAND.
 LICENSE NO. _____ EXPIRATION DATE: _____

PLAN VIEW

**UPLANDS PHASE 3-11
 POTOMAC OVERLOOK**

FORT WASHINGTON (12th) ELECTION DISTRICT, PRINCE GEORGE'S COUNTY, MARYLAND

Scale: 1" = 30'

SHEET **8** OF **8**

PROJECT NO. 1006-00-0V