

FILED

OCT 20 2022

CLERK OF THE CIRCUIT COURT
FOR PRINCE GEORGE'S COUNTY, MD

HALSEY WAY
PRIVATE ROAD

LAND UNIT 56-W

S 59°34'58" E 162.68'

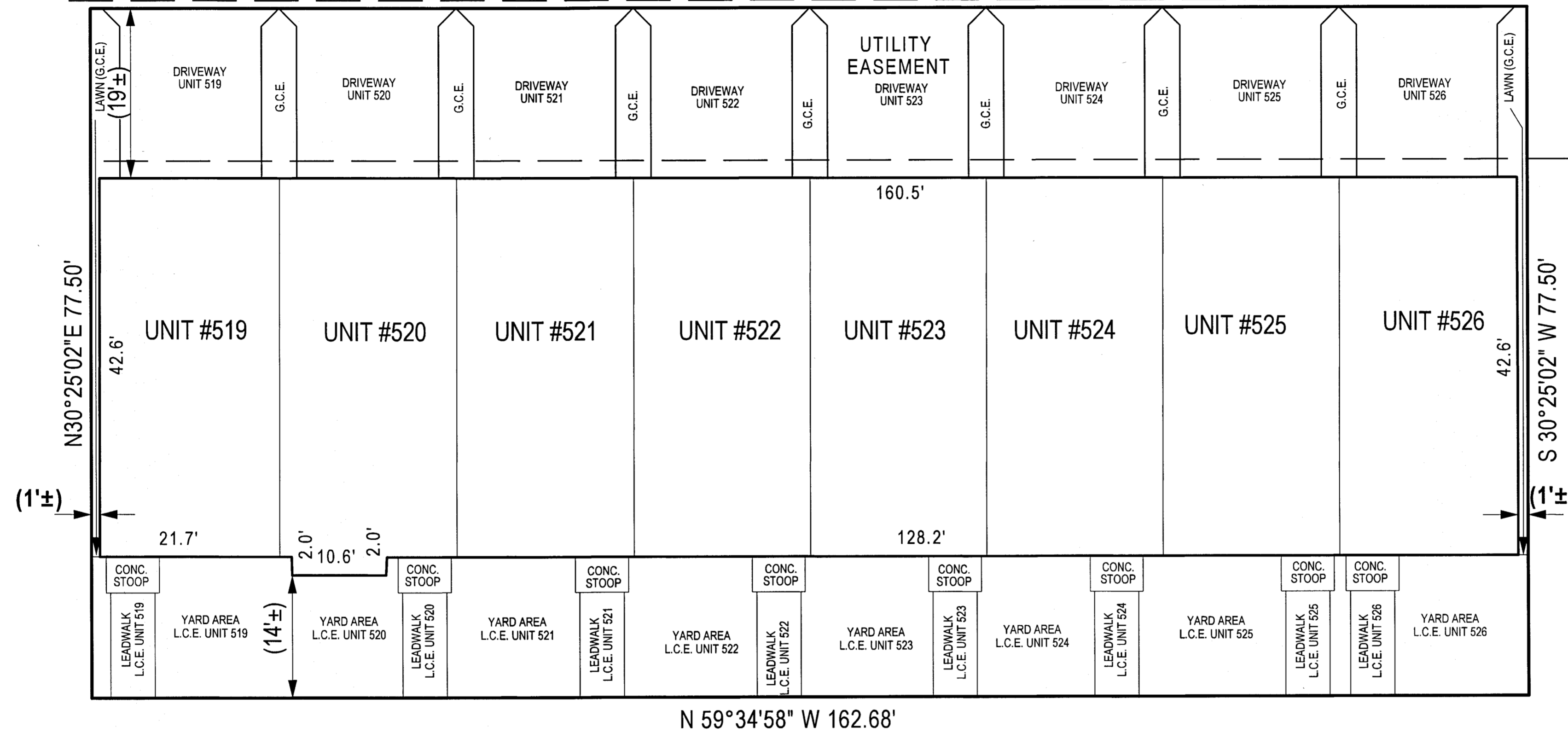

LAND UNIT
56-O
12,608 S.F.
0.2894 AC.

CONDOMINIUM PLAT
SHEET 2 OF 6
PHASE SIX
POTOMAC OVERLOOK
CONDOMINIUM IX EAST
OXON HILL (12th) ELECTION DISTRICT
PRINCE GEORGE'S COUNTY, MARYLAND
SCALE 1" = 10' JUNE, 2022

SOLTESZ, LLC

4300 Forbes Boulevard, Suite 230 Lanham, MD 20706 P.301.794.7555 F.301.794.7656
Engineering // Surveying // Planning // Environmental Sciences www.solteszco.com

- NOTES**
- 1) The dimensions given for the building shown hereon were measured along the exterior wall of the foundation.
 - 2) The driveway, and masonry porch and steps serving each Unit are part of the Unit.
 - 3) Limited common elements are designated hereon as L.C.E.
 - 4) General common elements are designated hereon as G.C.E.
 - 5) Walkways, driveways, porches, and stoops are intended to be constructed in the areas shown on the approved site plan.

RECORDED 10/20/2022
PLAT BOOK ME 2162
PLAT NO. 14

2257854

MSA C2381-21016-2

