

LAND UNIT 56-W
S 59°34'58" E 142.67'

SCALE: 1" = 10'
MD. ST. PLANE, NAD 27

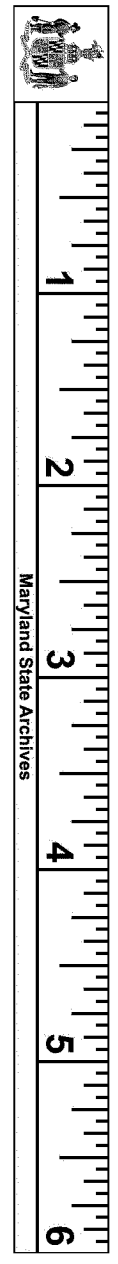

LAND UNIT 56-P

11,057 S.F.
0.2538 AC.

SECOND AMENDED
CONDOMINIUM PLAT
NATIONAL HARBOR
PARCEL 56
SITE CONDOMINIUM
P.B. ME 255 P.No. 99

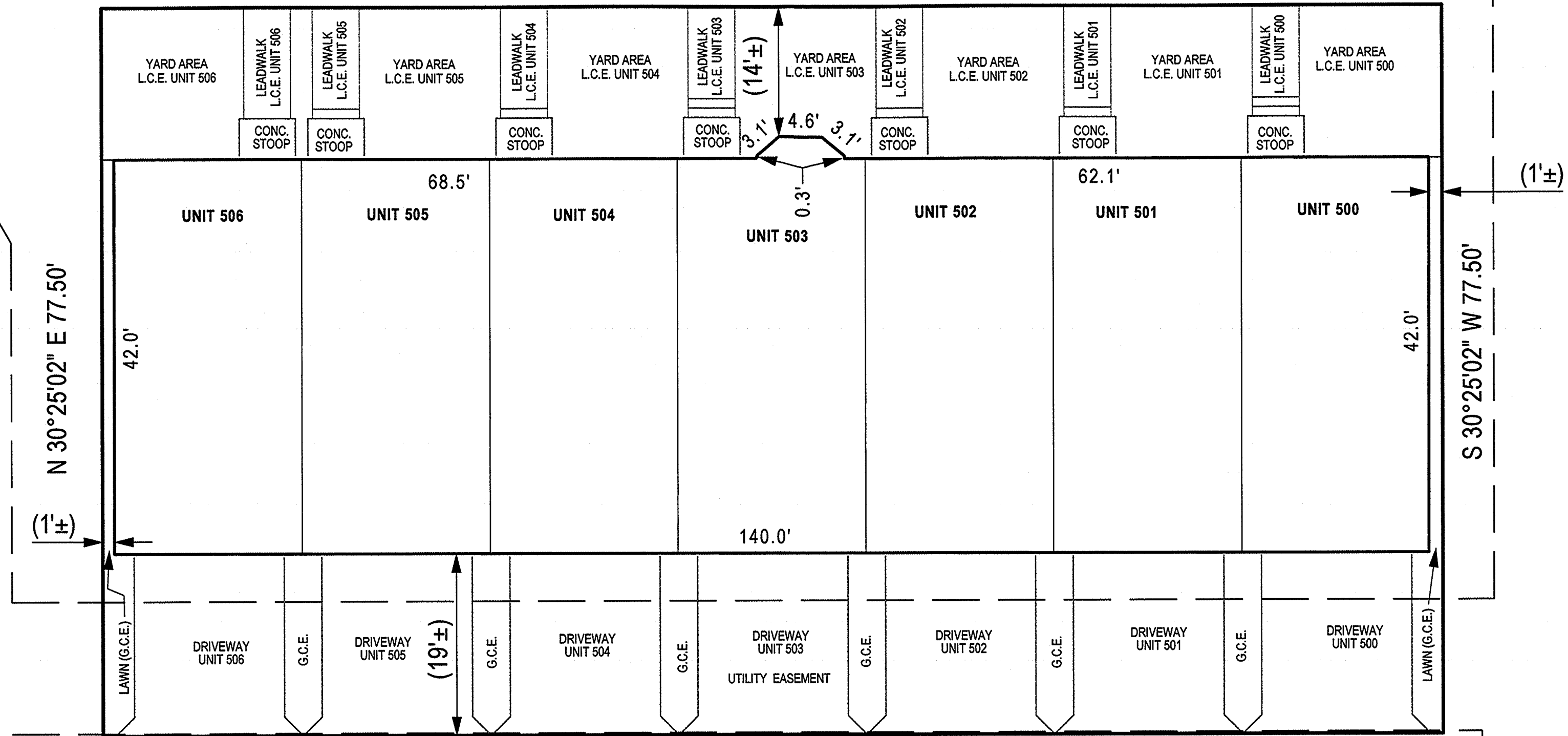

FILED

APR 05 2022

CLERK OF THE CIRCUIT COURT
FOR PRINCE GEORGE'S COUNTY, MD

NOTES

- 1) The dimensions given for the building shown hereon were measured along the exterior wall of the foundation.
- 2) The driveway, and masonry porch and steps serving each Unit are part of the Unit.
- 3) Limited common elements are designated hereon as L.C.E.
- 4) General common elements are designated hereon as G.C.E.
- 5) Walkways, driveways, porches, and stoops are intended to be constructed in the areas shown on the approved site plan.

RECORDED 4/5/22
 PLAT BOOK ME 260
 PLAT NO. 48

CONDOMINIUM PLAT
 SHEET 2 OF 6
PHASE THREE
POTOMAC OVERLOOK
CONDOMINIUM IX EAST

OXON HILL (12th) ELECTION DISTRICT
 PRINCE GEORGE'S COUNTY, MARYLAND
 SCALE 1" = 10' MARCH, 2022

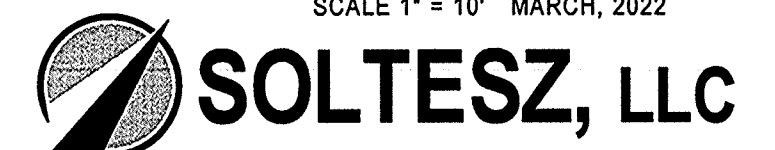

4300 Forbes Boulevard, Suite 230 Lanham, MD 20706 P.301.794.7555 F.301.794.7656
 Engineering // Surveying // Planning // Environmental Sciences www.solteszco.com

PD47 761

MSA C2381-20925-2