



LAND UNIT 56-V

LAND UNIT 56-F

FIRST AMENDED CONDOMINIUM PLAT NATIONAL HARBOR PARCEL 56 SITE CONDOMINIUM P.B. ME 255 P.No. 22

11,149 SQ.FT. OR 0.2560 AC.

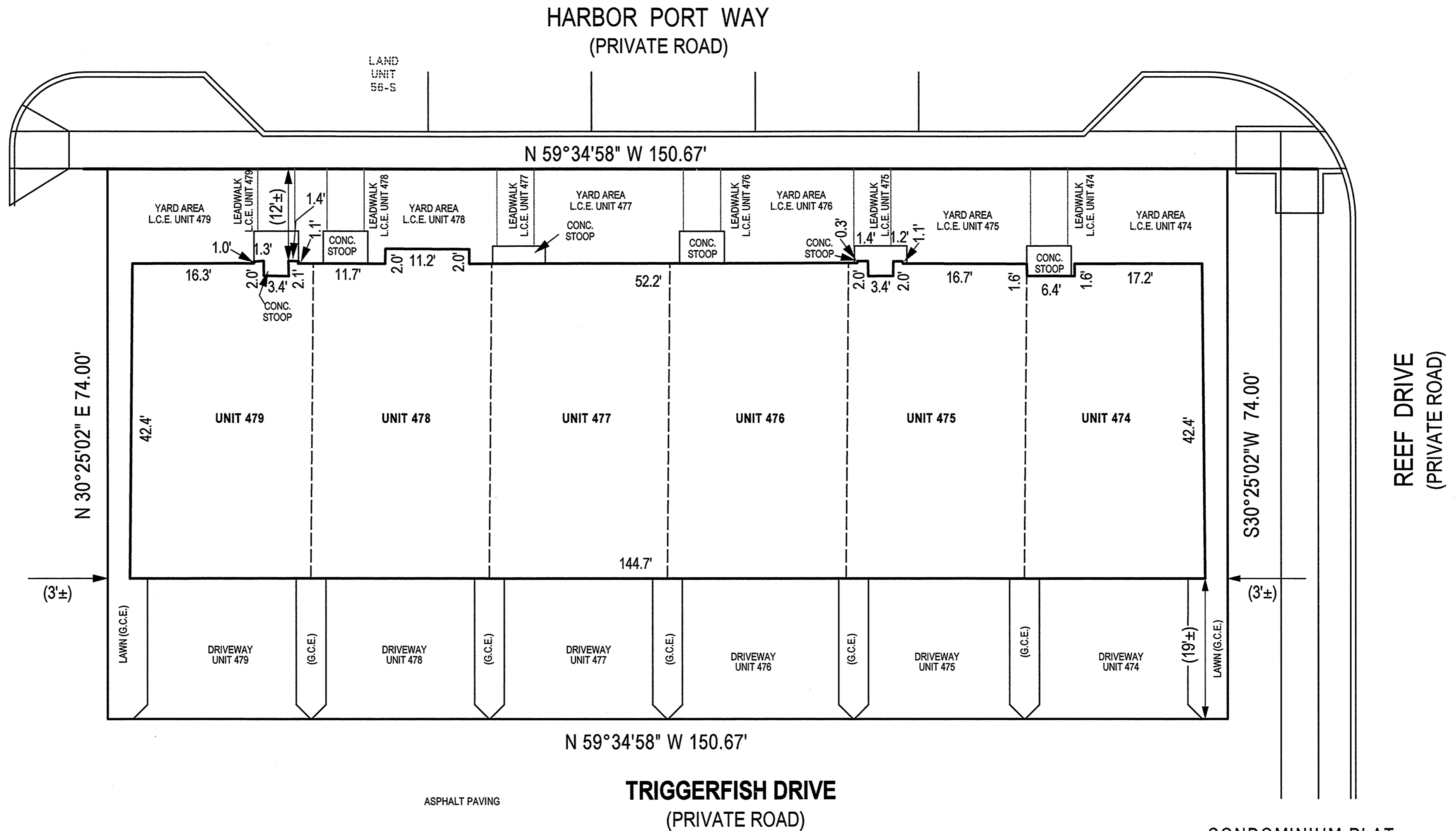

FILED

FEB 10 2021

CLERK OF THE CIRCUIT COURT FOR PRINCE GEORGE'S COUNTY, MD

NOTES

- 1) The dimensions given for the building hereon were measured along the exterior wall of the foundation.
- 2) The driveway, and masonry porch and steps serving each Unit are part of the Unit.
- 3) Limited common elements are designated hereon as L.C.E.
- 4) General common elements are designated hereon as G.C.E.
- 5) Walkways, driveways, porches, and stoops are intended to be constructed in the areas shown on the approved site plan.

RECORDED	02/10/2021
PLAT BOOK	ME 256
PLAT NO.	33

CONDOMINIUM PLAT SHEET 2 OF 5

PHASE TWO POTOMAC OVERLOOK CONDOMINIUM IX

OXON HILL (12th) ELECTION DISTRICT
PRINCE GEORGE'S COUNTY, MARYLAND
SCALE 1" = 10' JANUARY, 2021



4300 Forbes Boulevard, Suite 230 Lanham, MD 20706 P.301.794.7555 F.301.794.7656
Engineering // Surveying // Planning // Environmental Sciences www.solteszco.com

P240 537

MSA S1250-20192-2