

LAND UNIT 56-D  
9,481 S.F.  
0.2177 AC.

LAND UNIT 56-V

LAND UNIT 56-V

S 59°34'58" E 122.34'

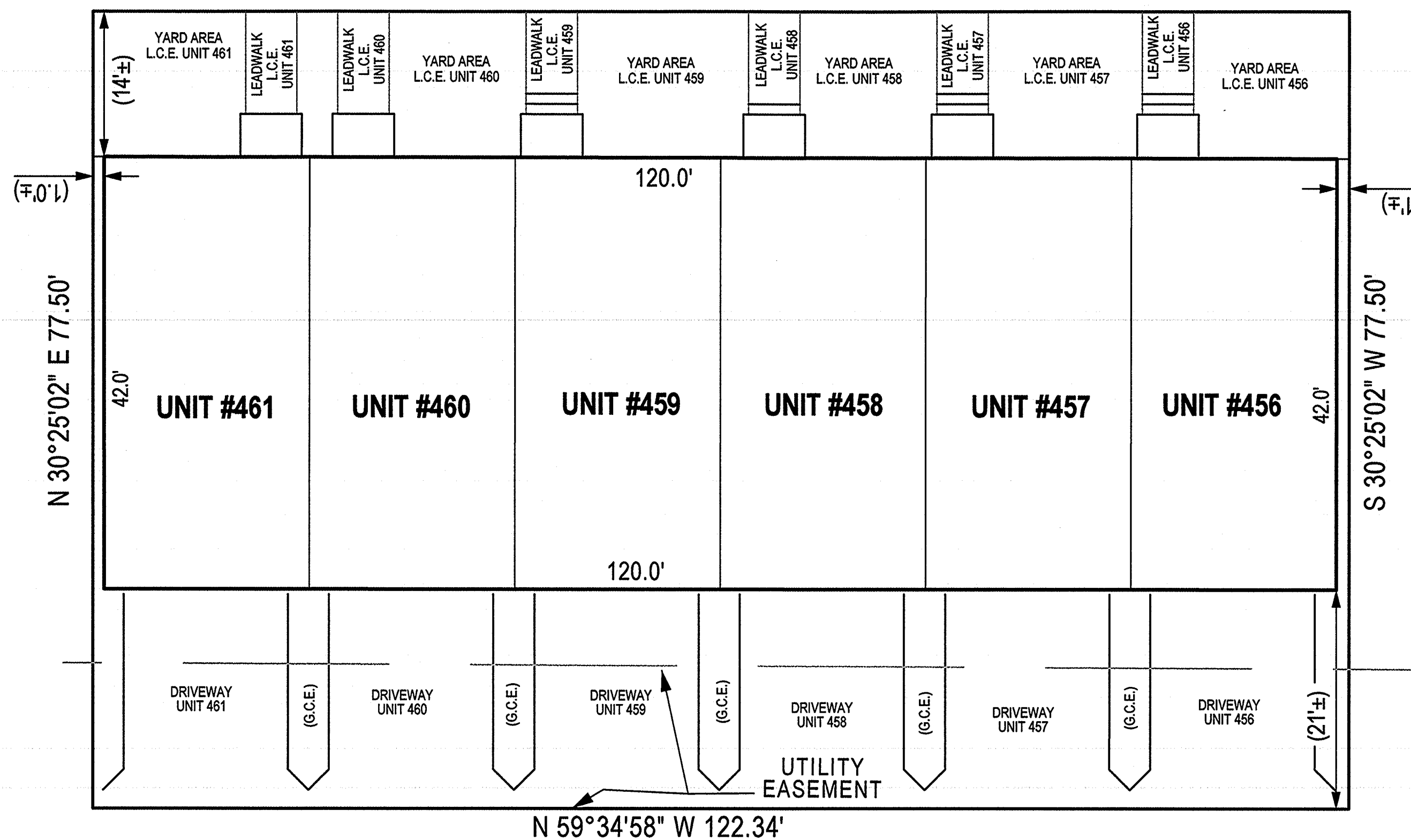

LAND UNIT 56-V

WINDBOARD WAY

FILED

JUN 20 2021

CLERK OF THE CIRCUIT COURT FOR PRINCE GEORGE'S COUNTY, MD

NOTES

- 1) The dimensions given for the building shown hereon were measured along the exterior wall of the foundation.
- 2) The driveway, and masonry porch and steps serving each Unit are part of the Unit.
- 3) Limited common elements are designated hereon as L.C.E.
- 4) General common elements are designated hereon as G.C.E.
- 5) Walkways, driveways, porches, and stoops are intended to be constructed in the areas shown on the approved site plan.

RECORDED 7-20-2021  
 PLAT BOOK ME 257  
 PLAT NO. 96

CONDOMINIUM PLAT  
 SHEET 2 OF 5  
 PHASE FIVE  
 POTOMAC OVERLOOK  
 CONDOMINIUM IX  
 OXON HILL (12th) ELECTION DISTRICT  
 PRINCE GEORGE'S COUNTY, MARYLAND  
 SCALE 1" = 10' JUNE, 2021



4300 Forbes Boulevard, Suite 230 Lanham, MD 20706 P.301.794.7555 F.301.794.7656  
 Engineering // Surveying // Planning // Environmental Sciences www.solteszco.com

P243036

MSA C2381-20769-2