

LAND UNIT 56-E
7,495 S.F.
0.1721 AC.

FILED

SEP 15 2021

CLERK OF THE CIRCUIT COURT
FOR PRINCE GEORGE'S COUNTY, MD

LAND UNIT 56-V

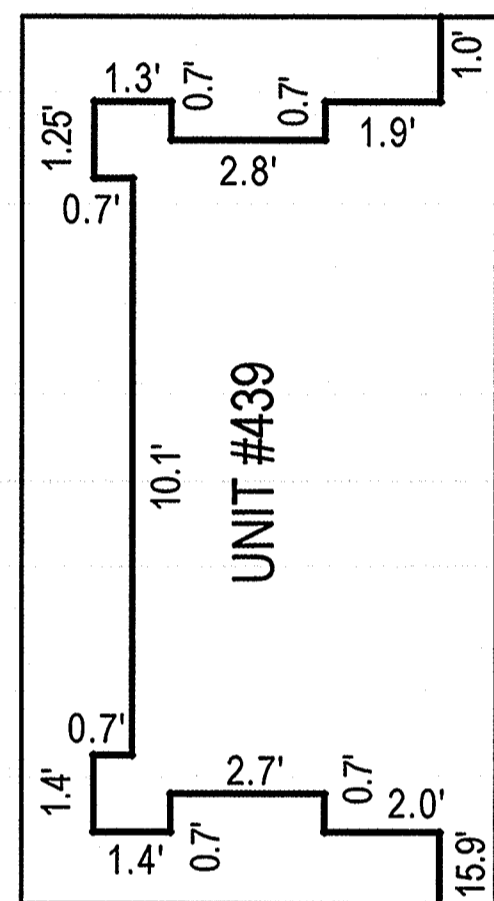

INSET N.T.S.

WINDBOARD WAY

S 59°34'58" E 108.62'

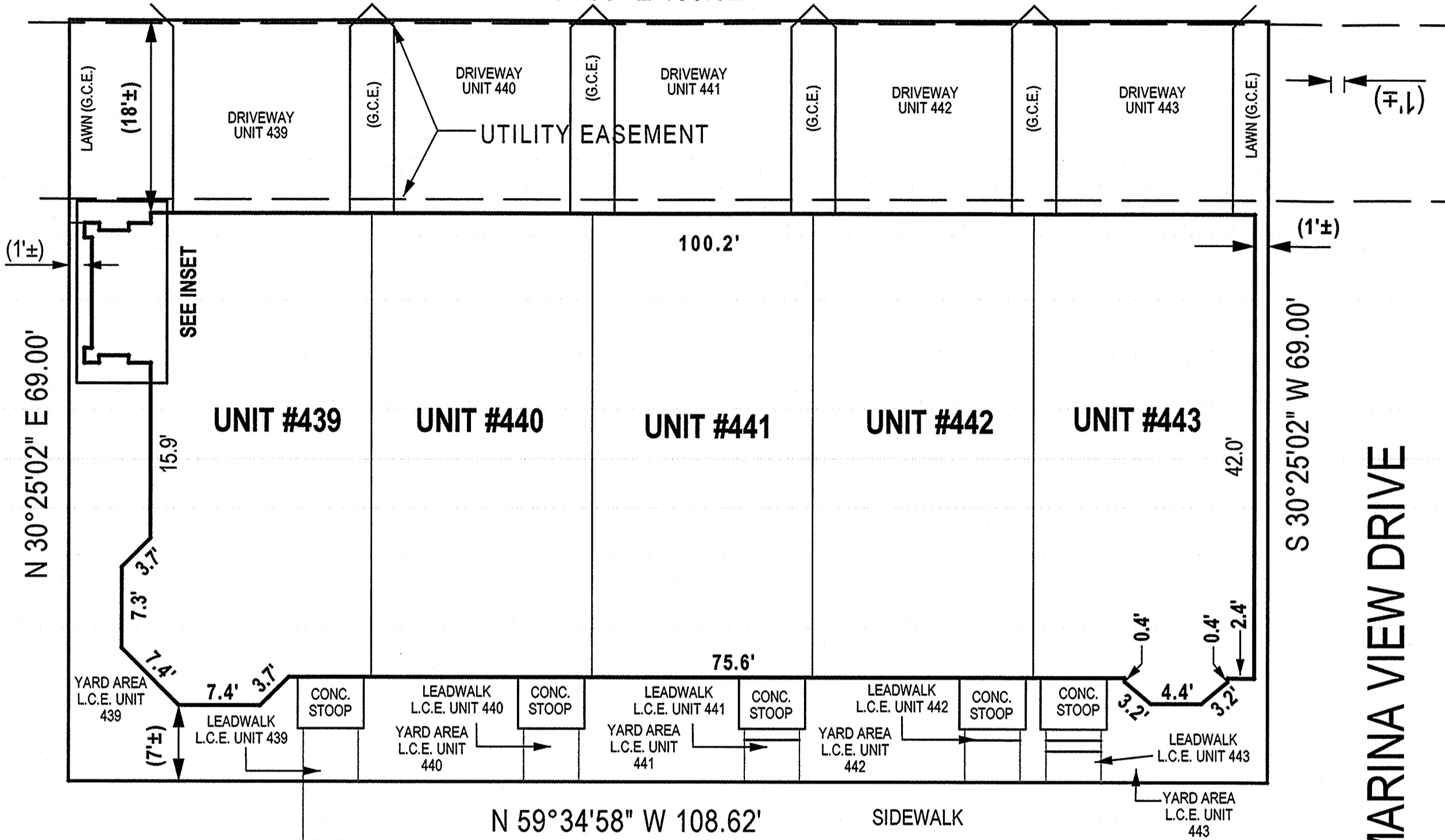

LAND UNIT 56-V

- NOTES
- 1) The dimensions given for the building shown hereon were measured along the exterior wall of the foundation.
 - 2) The driveway, and masonry porch and steps serving each Unit are part of the Unit.
 - 3) Limited common elements are designated hereon as L.C.E.
 - 4) General common elements are designated hereon as G.C.E.
 - 5) Walkways, driveways, porches, and stoops are intended to be constructed in the areas shown on the approved site plan.

RECORDED 9-15-2021
 PLAT BOOK ME 259
 PLAT NO. 50

CONDOMINIUM PLAT
 SHEET 2 OF 5
 PHASE SIX
 POTOMAC OVERLOOK
 CONDOMINIUM IX

OXON HILL (12th) ELECTION DISTRICT
 PRINCE GEORGE'S COUNTY, MARYLAND
 SCALE 1" = 10' JUNE, 2021



4300 Forbes Boulevard, Suite 230 Lanham, MD 20706 P.301.794.7555 F.301.794.7656
 Engineering // Surveying // Planning // Environmental Sciences www.solteszco.com

P243552

MSA S1250-20330-2