

SJH242 19

LAND UNIT 42-T
NATIONAL HARBOR
PARCEL 42
SITE CONDOMINIUM
P.B. MMB 240 P.No.33

S 9°38'37" E 109.85'

LAWN (G.C.E.)

DATUM: MD STATE PLANE NAD 27 FT

SCALE: 1" = 10'

NOTES

- 1) The dimensions given for the building shown hereon were measured along the exterior wall of the foundation.
- 2) The driveway and concrete stoop serving each Unit is part of the Unit.
- 3) Limited common elements are designated hereon as L.C.E.
- 4) General common elements are designated hereon as G.C.E.
- 5) Walkways, driveways, porches, and stoops are intended to be constructed in the areas shown on the approved site plan.

REGENTS SQUARE
(PRIVATE ROAD)

LAND UNIT 42-R
NATIONAL HARBOR
PARCEL 42
SITE CONDOMINIUM
P.B. MMB 240 P.No.33
15,442 sq.ft. or 0.3545 ac.

PHASE THREE
POTOMAC OVERLOOK
CONDOMINIUM VI

ASPHALT PAVING (G.C.E.)

(S)

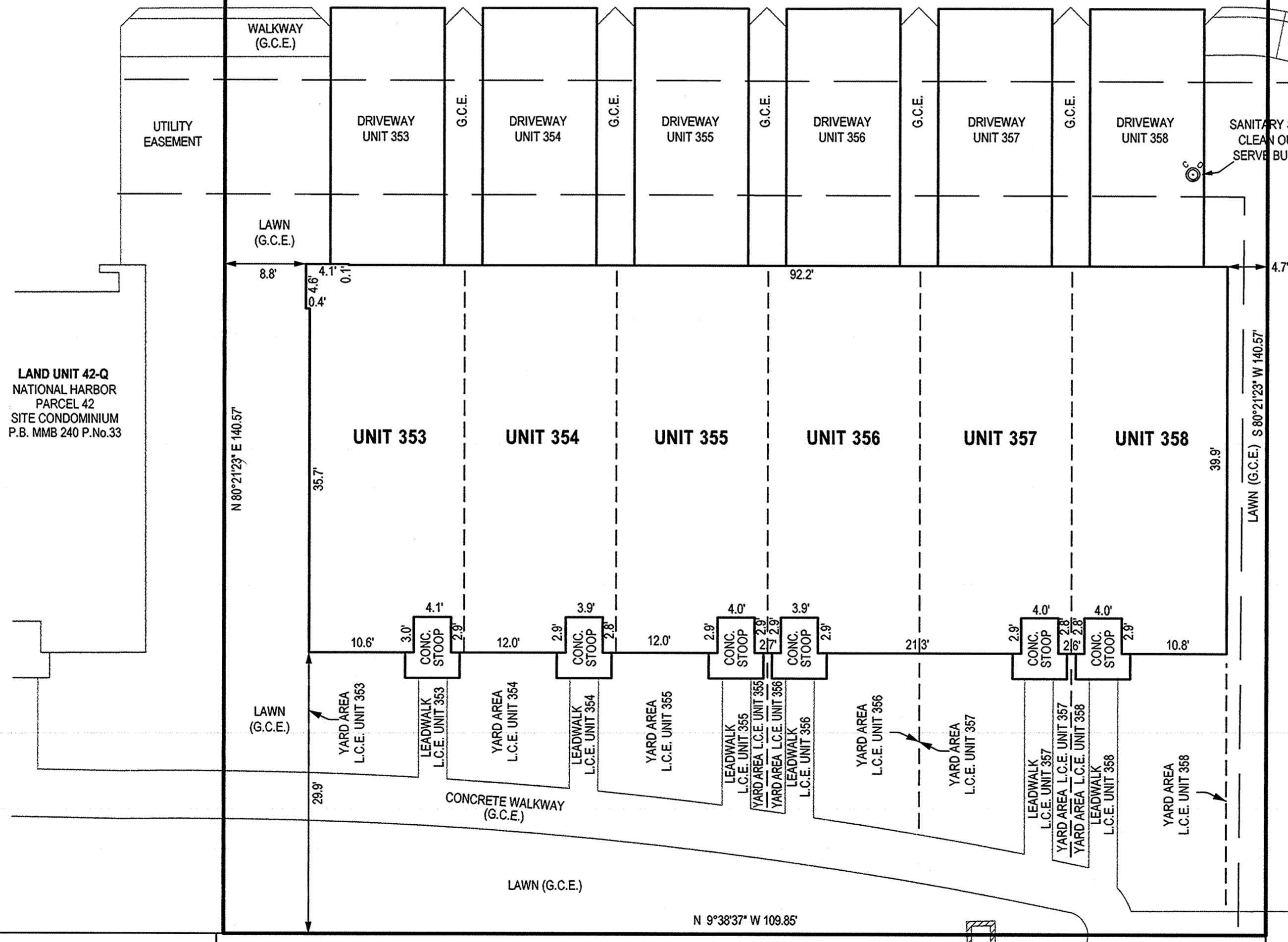
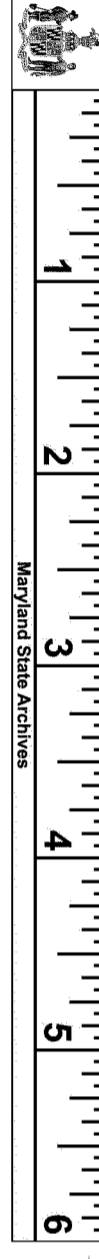

LAND UNIT 42-Q
NATIONAL HARBOR
PARCEL 42
SITE CONDOMINIUM
P.B. MMB 240 P.No.33

LAND UNIT 42-T
NATIONAL HARBOR
PARCEL 42
SITE CONDOMINIUM
P.B. MMB 240 P.No.33

(D)

REGENTS SQUARE
(PRIVATE ROAD)

FILED

MAR 16 2015

CLERK OF THE CIRCUIT COURT
FOR PRINCE GEORGES COUNTY, MD.

CONDOMINIUM PLAT
SHEET 2 OF 4
**PHASE THREE
POTOMAC OVERLOOK
CONDOMINIUM VI**
OXON HILL (12th) ELECTION DISTRICT
PRINCE GEORGE'S COUNTY, MARYLAND
SCALE 1" = 10' MARCH 2015

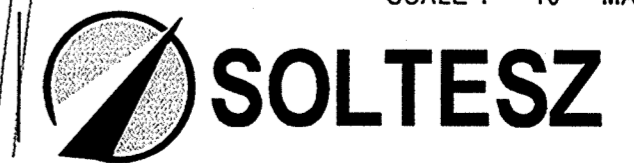

LANHAM OFFICE
4300 Forbes Boulevard, Suite 230 Lanham, MD 20706 P.301.794.7555 F.301.794.7656
Engineering Planning Environmental Sciences www.solteszco.com

RECORDED 3116115
PLAT BOOK SJH242
PLAT NO. 19

PHASE TWO
POTOMAC OVERLOOK
CONDOMINIUM VII
P.B. MMB 241 P.Nos. 47 - 51

LAND UNIT 42-P
NATIONAL HARBOR
PARCEL 42
SITE CONDOMINIUM
P.B. MMB 240 P.No.33

PHASE ONE
POTOMAC OVERLOOK
CONDOMINIUM VIII
P.B. MMB 241 P.Nos. 42 - 45

LAND UNIT 42-O
NATIONAL HARBOR
PARCEL 42
SITE CONDOMINIUM
P.B. MMB 240 P.No.33

P.208807 MSA 31250-19348-2