

MMB 241 48

PRINCE GEORGE'S COUNTY CIRCUIT COURT (Plat Book) MMB 241, pp. 47-51, MSA_C2381_19770. Date available 2014/10/29. Printed 02/01/2023.

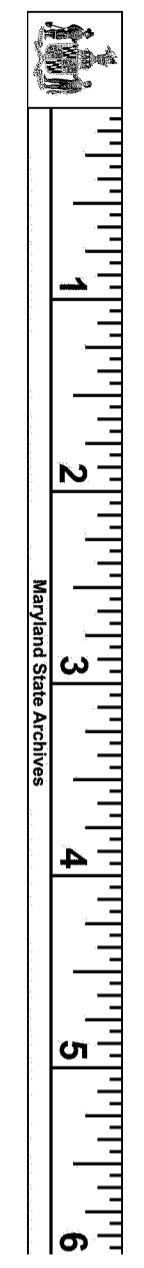

DATUM: MD STATE PLANE NAD 27 FT
SCALE: 1" = 10'

LAND UNIT 42-K
NATIONAL HARBOR
PARCEL 42
SITE CONDOMINIUM
P.B. MMB 240 P.No.33

LAND UNIT 42-L
NATIONAL HARBOR
PARCEL 42
SITE CONDOMINIUM
P.B. MMB 240 P.No.33

NATIONAL HARBOR
PARCEL 42
SITE CONDOMINIUM
P.B. MMB 240 P.No.33

LAND UNIT 42-Q
NATIONAL HARBOR
PARCEL 42
SITE CONDOMINIUM
P.B. MMB 240 P.No.33

LAND UNIT 42-R
NATIONAL HARBOR
PARCEL 42
SITE CONDOMINIUM
P.B. MMB 240 P.No.33

LAND UNIT 42-P
NATIONAL HARBOR
PARCEL 42
SITE CONDOMINIUM
P.B. MMB 240 P.No.33
15,630 sq.ft. or 0.3588 ac.

PHASE TWO
POTOMAC OVERLOOK
CONDOMINIUM VI

PHASE ONE
POTOMAC OVERLOOK
CONDOMINIUM VII
P.B. MMB XXX P.Nos. XX - XX

LAND UNIT 42-O
NATIONAL HARBOR
PARCEL 42
SITE CONDOMINIUM
P.B. MMB 240 P.No.33

REGENTS SQUARE
(PRIVATE ROAD)

REGENTS SQUARE
(PRIVATE ROAD)

PARCEL 42
PLAT TWENTY
NATIONAL HARBOR
P.B. MMB 239 P.No. 46

CONDOMINIUM PLAT
SHEET 2 OF 5
**PHASE TWO
POTOMAC OVERLOOK
CONDOMINIUM VI**

OXON HILL (12th) ELECTION DISTRICT
PRINCE GEORGE'S COUNTY, MARYLAND
SCALE 1" = 10' NOVEMBER 2014



LANHAM OFFICE
4300 Forbes Boulevard, Suite 230 Lanham, MD 20706 P.301.794.7555 F.301.794.7656
Engineering Planning Environmental Sciences www.solteszco.com

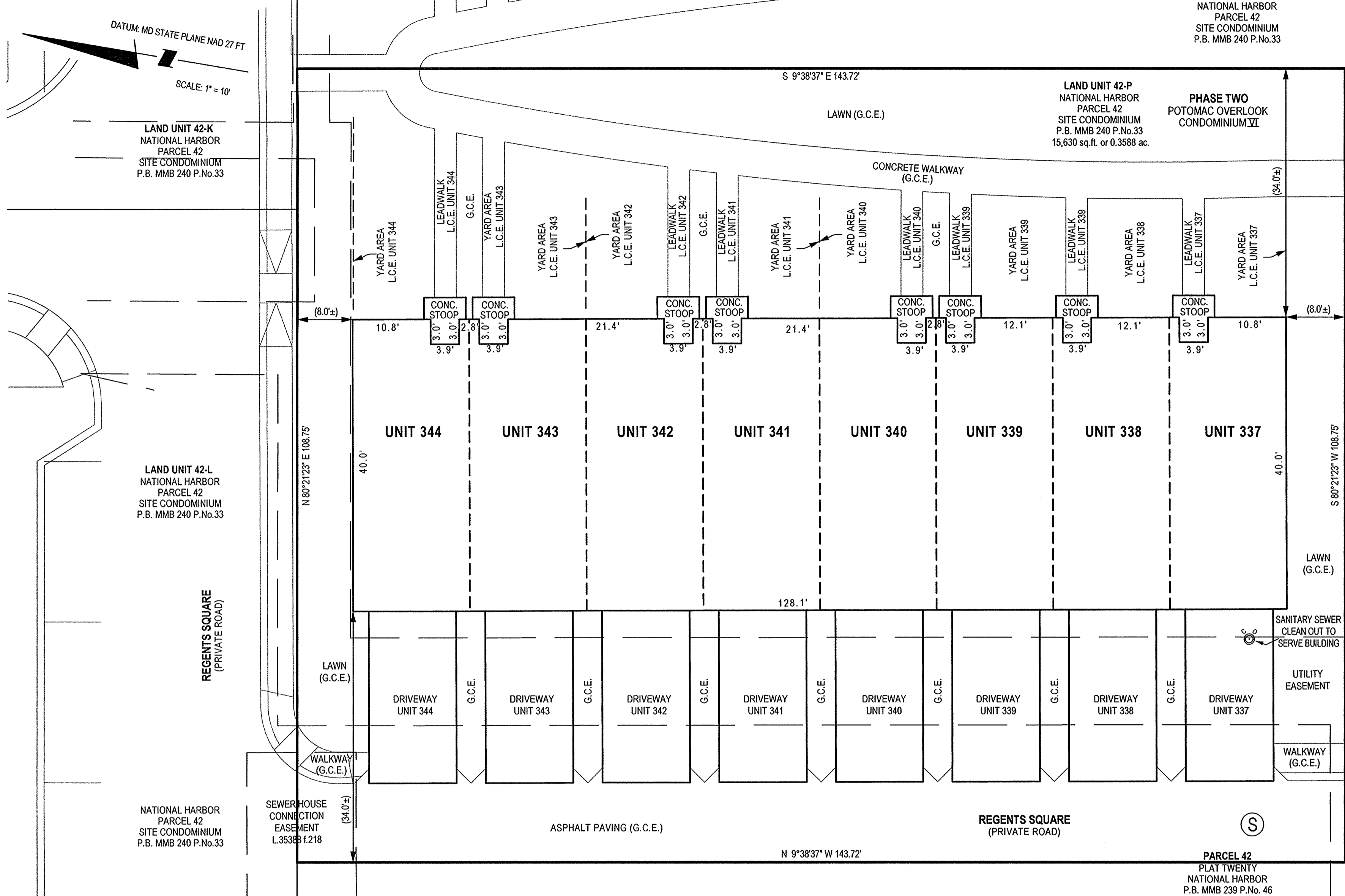

NOTES

- 1) The dimensions given for the building shown hereon were measured along the exterior wall of the foundation.
- 2) The driveway and concrete stoop serving each Unit is part of the Unit.
- 3) Limited common elements are designated hereon as L.C.E.
- 4) General common elements are designated hereon as G.C.E.
- 5) Walkways, driveways, porches, and stoops are intended to be constructed in the areas shown on the approved site plan.

RECORDED 10/29/14
PLAT BOOK MMB 241
PLAT NO. 48

FILED

OCT 29 2014

CLERK OF THE CIRCUIT COURT
PRINCE GEORGE'S COUNTY, MD.

S:\1006-01\urands\SURVEY\Plats\potomac-overlook-combo-VI\phase-02-sheet-2.sh Scale= 10:0000 ft / in. User= Poulble PLTdrv= Grey.pltctg Penmb= TEXT SUB.tbl 10/27/2014 12:56:28 PM

P. 207099 MSA C2381-19770-2