

SJH244 68

PRINCE GEORGE'S COUNTY CIRCUIT COURT (Plat Book) Plat Book SJH 244, pp. 67-71, MSA_C2381_19973. Date available 2016/04/25. Printed 02/01/2023.

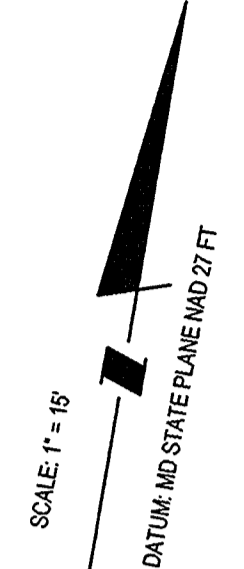
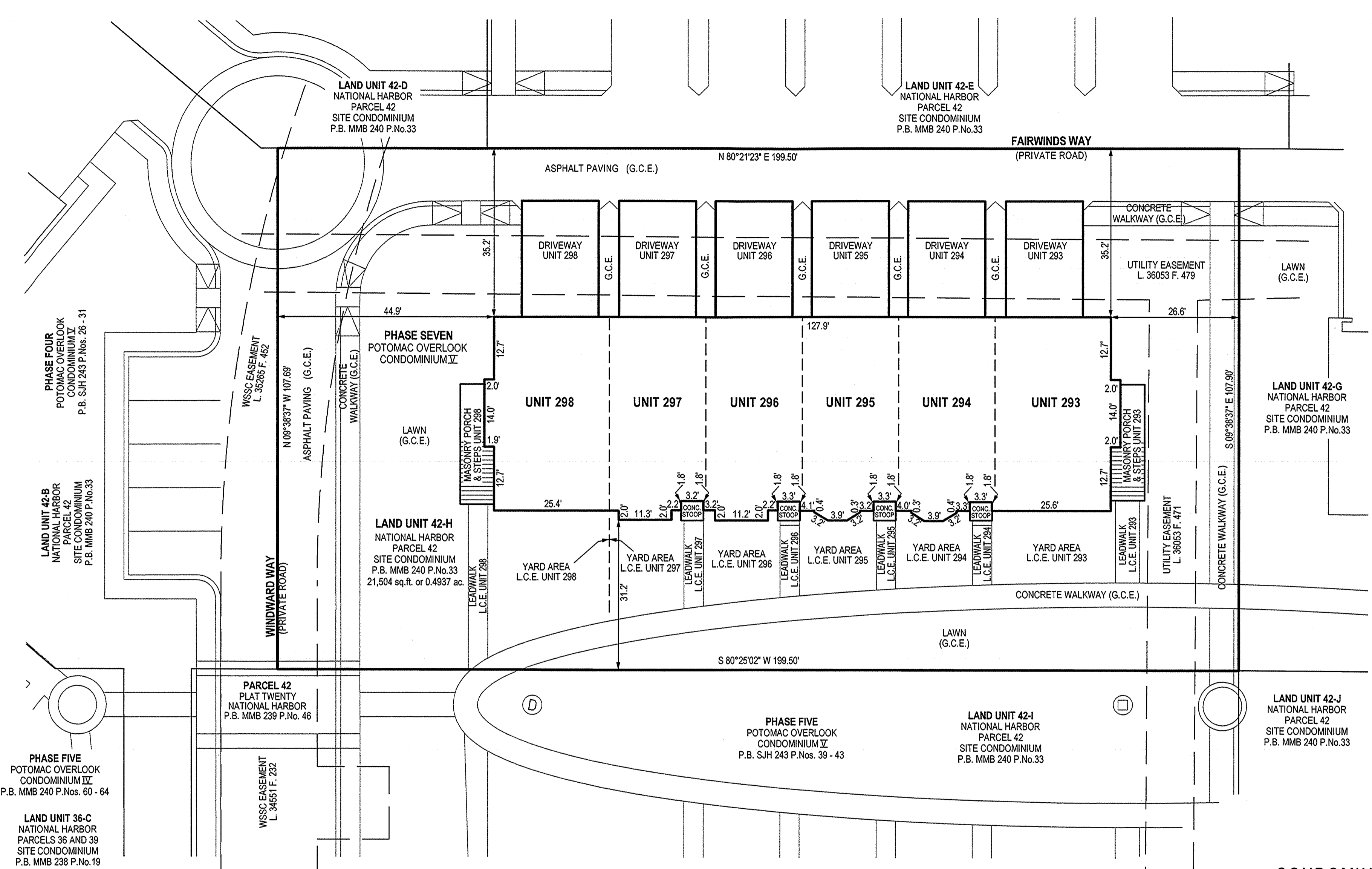

FILED
APR 25 2016
CLERK OF THE CIRCUIT COURT
FOR PRINCE GEORGE'S COUNTY, MD

- NOTES**
- 1) The dimensions given for the building shown hereon were measured along the exterior wall of the foundation.
 - 2) The driveway and concrete stoop serving each Unit is part of the Unit.
 - 3) Limited common elements are designated hereon as L.C.E.
 - 4) General common elements are designated hereon as G.C.E.
 - 5) Walkways, driveways, porches, and stoops are intended to be constructed in the areas shown on the approved site plan.

RECORDED 4/25/16
PLAT BOOK SJH244
PLAT NO. 68

CONDOMINIUM PLAT
SHEET 2 OF 5
**PHASE SEVEN
POTOMAC OVERLOOK
CONDOMINIUM V**
OXON HILL (12th) ELECTION DISTRICT
PRINCE GEORGE'S COUNTY, MARYLAND
SCALE 1" = 15' APRIL 2015

 **SOLTESZ, LLC**

4300 Forbes Boulevard, Suite 230 Lanham, MD 20706 P.301.794.7555 F.301.794.7656
Engineering // Surveying // Planning // Environmental Sciences www.solteszco.com

2215346

MSA C2381-19973-2

S:\1006-01\planets\SURVEY\Plat\potomac-overlook-condo-V\phase-07-sheet-2.sht Scale= 15.0000 ft/in. User= P:\quibler\PLT\dwg-Gray.plt\pldg Penribl= TEXT SUB.tbl 4/21/2016 2:30:18 PM