

SJH245 25

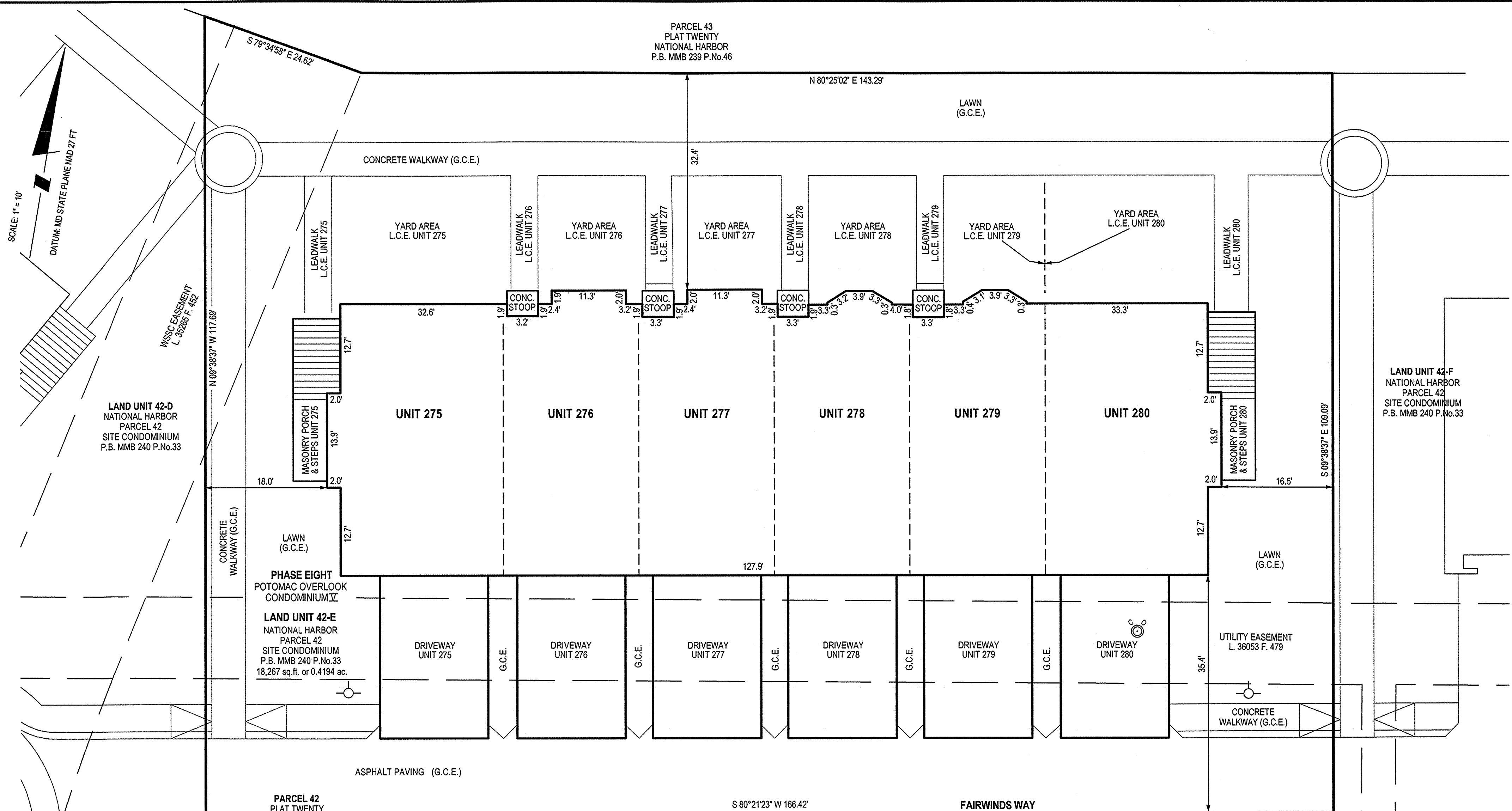

PARCEL 43
PLAT TWENTY
NATIONAL HARBOR
P.B. MMB 239 P.No.46

LAND UNIT 42-D
NATIONAL HARBOR
PARCEL 42
SITE CONDOMINIUM
P.B. MMB 240 P.No.33

LAND UNIT 42-E
NATIONAL HARBOR
PARCEL 42
SITE CONDOMINIUM
P.B. MMB 240 P.No.33
18,267 sq.ft. or 0.4194 ac.

PARCEL 42
PLAT TWENTY
NATIONAL HARBOR
P.B. MMB 239 P.No. 46

PHASE SEVEN
POTOMAC OVERLOOK
CONDOMINIUM V
P.B. SJH 244 P.Nos. 67 - 71

LAND UNIT 42-H
NATIONAL HARBOR
PARCEL 42
SITE CONDOMINIUM
P.B. MMB 240 P.No.33

LAND UNIT 42-F
NATIONAL HARBOR
PARCEL 42
SITE CONDOMINIUM
P.B. MMB 240 P.No.33

PHASE SEVEN
POTOMAC OVERLOOK
CONDOMINIUM V
P.B. SJH 245 P.Nos. 7 - 10

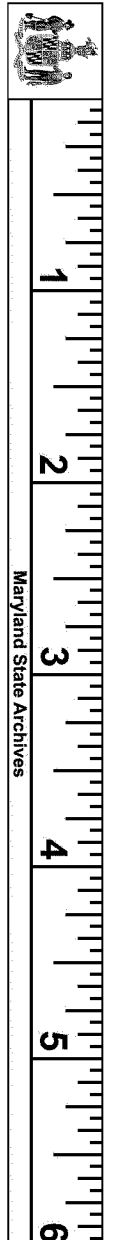

NOTES

- 1) The dimensions given for the building shown hereon were measured along the exterior wall of the foundation.
- 2) The driveway and concrete stoop or masonry porch serving each Unit is part of the Unit.
- 3) Limited common elements are designated hereon as L.C.E.
- 4) General common elements are designated hereon as G.C.E.
- 5) Walkways, driveways, porches, and stoops are intended to be constructed in the areas shown on the approved site plan.

FILED

JUL 29 2016

CLERK OF THE CIRCUIT COURT FOR PRINCE GEORGE'S COUNTY, MD

CONDOMINIUM PLAT
SHEET 2 OF 5
**PHASE EIGHT
POTOMAC OVERLOOK
CONDOMINIUM V**
OXON HILL (12th) ELECTION DISTRICT
PRINCE GEORGE'S COUNTY, MARYLAND
SCALE 1" = 10' JULY 2016

SOLTESZ, LLC
LANHAM OFFICE

4300 Forbes Boulevard, Suite 230 Lanham, MD 20706 P.301.794.7555 F.301.794.7656
Engineering // Surveying // Planning // Environmental Sciences

RECORDED 7/28/16
PLAT BOOK SJH245
PLAT NO. 25

P216897

MSA C2381-20012-2

PRINCE GEORGE'S COUNTY CIRCUIT COURT (Plat Book) Plat Book SJH 245, pp. 24-28, MSA_C2381_20012. Date available 2016/07/26. Printed 02/01/2023.

S:\1005-011\plans\SURVEY\Plats\potomac-overlook-condo-v\phase-08-sheet-2.sht Scale= 10,0000 ft. in. User= P\Quibbe PLTdm= Gray\plc\g Penib= TEXT SUBJ:tbl 7/22/2016 11:04:21 AM 03/01/16