

PARCEL 43
PLAT TWENTY
P.B. MMB 239 P.NO.46

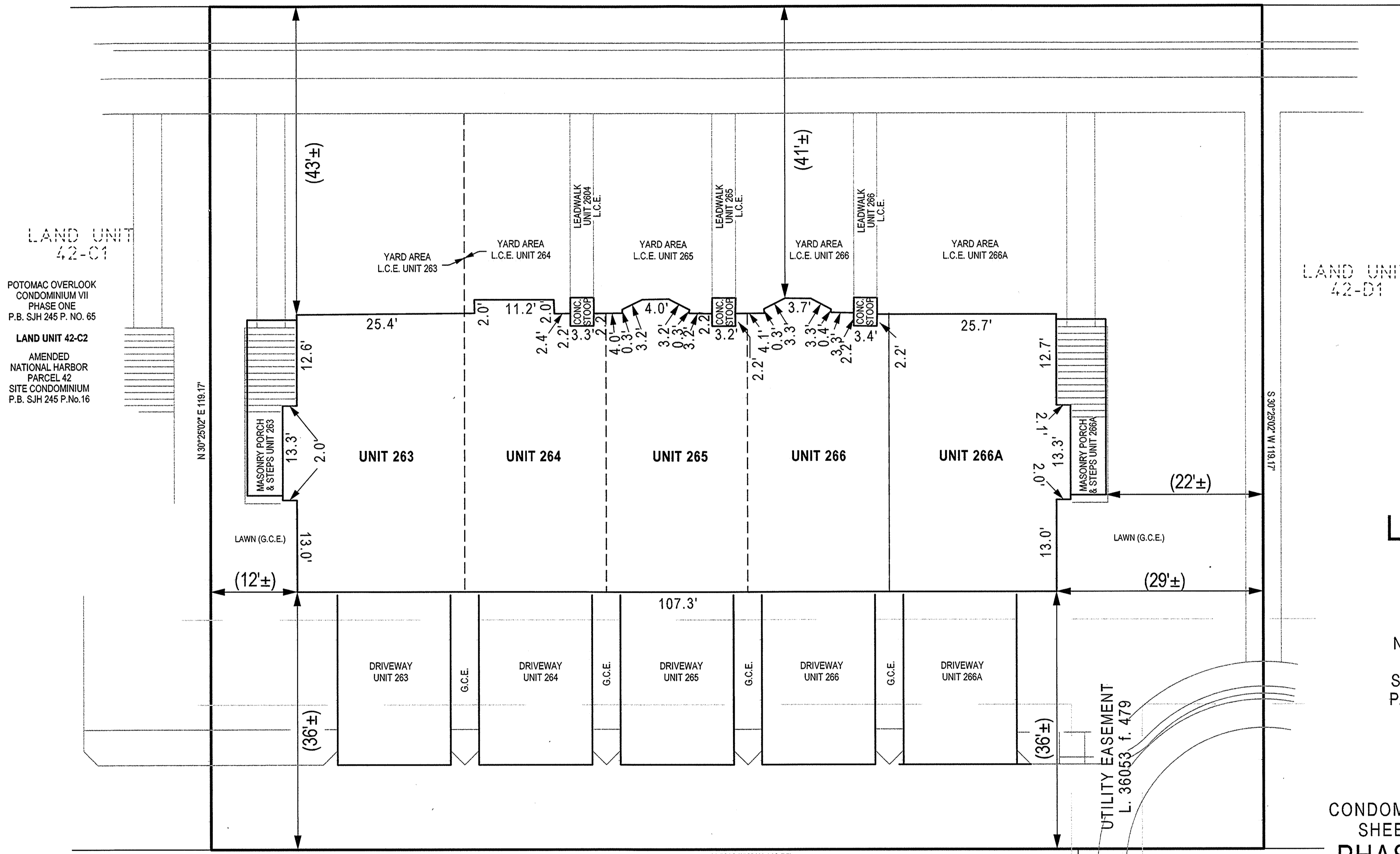
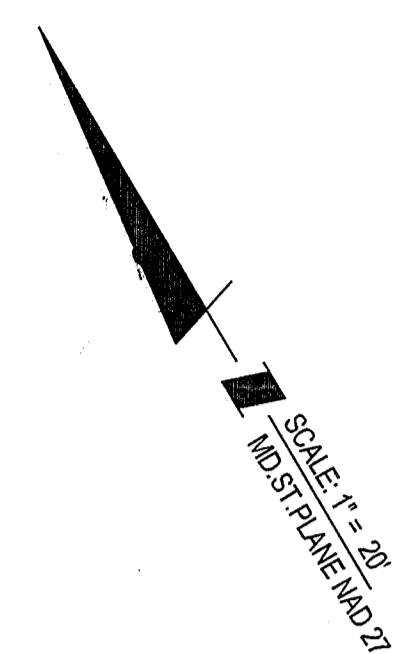

LAND UNIT 42-C1
POTOMAC OVERLOOK CONDOMINIUM VII PHASE ONE P.B. SJH 245 P. NO. 65
LAND UNIT 42-C2 AMENDED NATIONAL HARBOR PARCEL 42 SITE CONDOMINIUM P.B. SJH 245 P.No.16

LAND UNIT 42-D1

LAND UNIT 42-C2
17,726 S.F.
0.4069 AC.
NATIONAL HARBOR PARCEL 42
SITE CONDOMINIUM P.B. SJH 245 P.No. 16

CONDOMINIUM PLAT SHEET 2 OF 5
PHASE TWO POTOMAC OVERLOOK CONDOMINIUM VII
OXON HILL (12th) ELECTION DISTRICT
PRINCE GEORGE'S COUNTY, MARYLAND
SCALE 1" = 10' NOVEMBER 2016



FAIR WINDS WAY (PRIVATE ROAD)

LAND UNIT 42-A

LAND UNIT 42-S

- NOTES
- 1) The dimensions given for the building shown hereon were measured along the exterior wall of the foundation.
 - 2) The driveway, and masonry porch and steps serving each Unit are part of the Unit.
 - 3) Limited common elements are designated hereon as L.C.E.
 - 4) General common elements are designated hereon as G.C.E.
 - 5) Walkways, driveways, porches, and stoops are intended to be constructed in the areas shown on the approved site plan.

RECORDED 11/29/16
PLAT BOOK SJH246
PLAT NO. 22

FILED

NOV 29 2016

CLERK OF THE CIRCUIT COURT FOR PRINCE GEORGE'S COUNTY, MD

SOLTESZ, LLC

4300 Forbes Boulevard, Suite 230 Lanham, MD 20706 P.301.794.7555 F.301.794.7656
Engineering // Surveying // Planning // Environmental Sciences www.solteszco.com