

SJH 245-66

PRINCE GEORGE'S COUNTY CIRCUIT COURT (Plat Book) Plat Book SJH 245, pp. 65-69, MSA_C2381_20041. Date available 2016/09/27. Printed 02/01/2023.

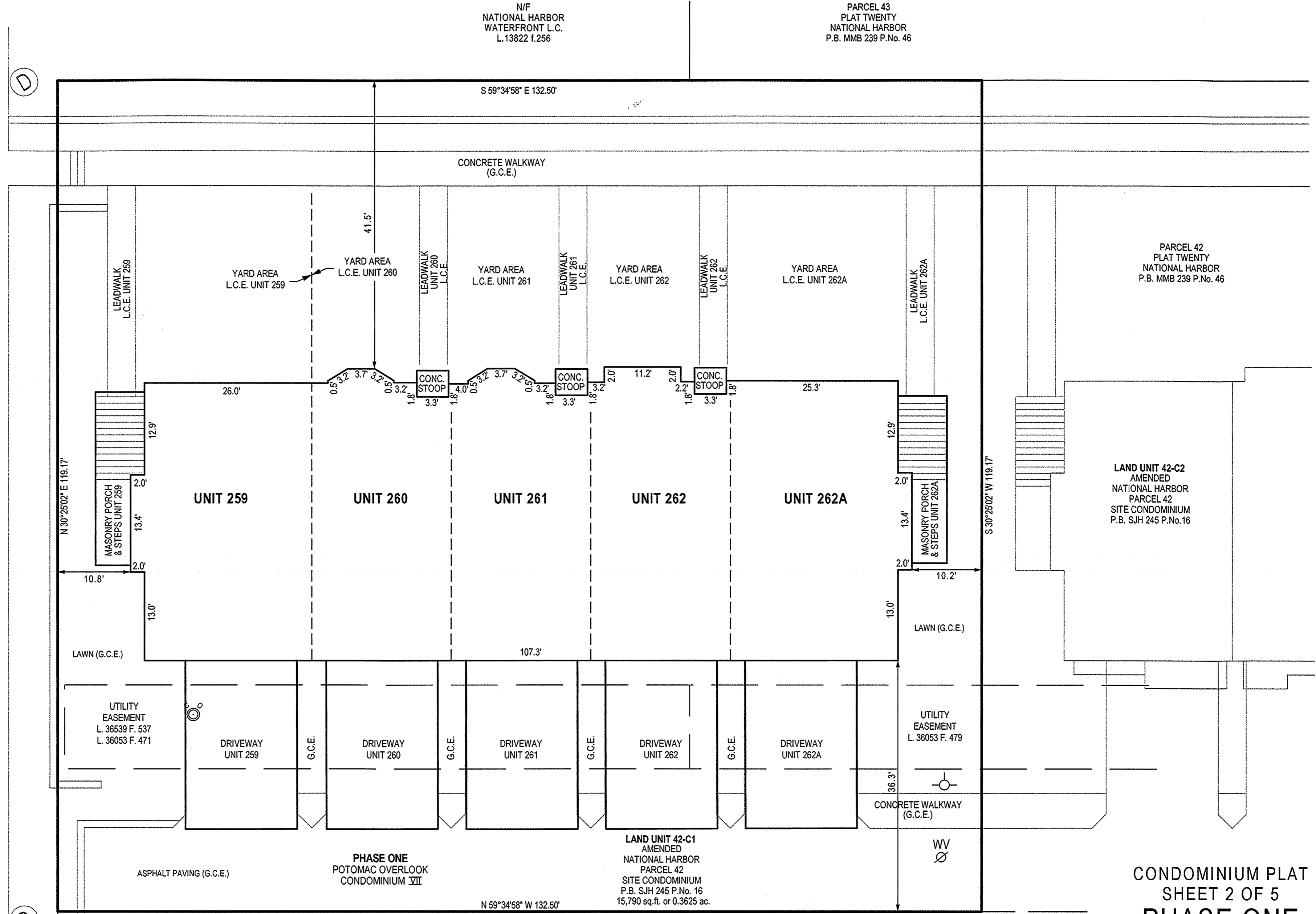
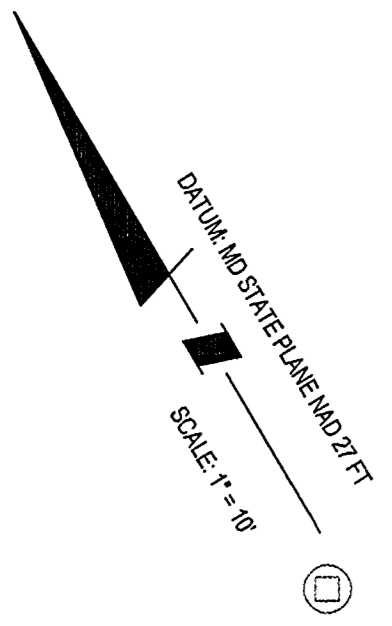
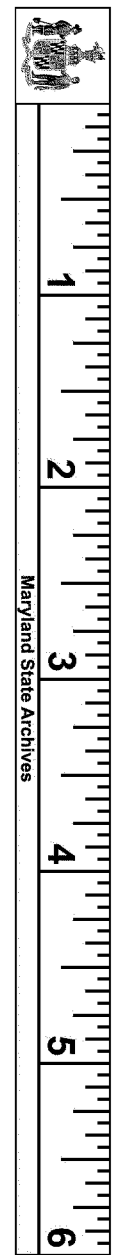

N/F NATIONAL HARBOR WATERFRONT L.C. L.13822 f.256

N/F NATIONAL HARBOR WATERFRONT L.C. L.13822 f.256

PARCEL 43 PLAT TWENTY NATIONAL HARBOR P.B. MMB 239 P.No. 46

PARCEL 42 PLAT TWENTY NATIONAL HARBOR P.B. MMB 239 P.No. 46

LAND UNIT 42-C2 AMENDED NATIONAL HARBOR PARCEL 42 SITE CONDOMINIUM P.B. SJH 245 P.No.16

LAND UNIT 42-C1 AMENDED NATIONAL HARBOR PARCEL 42 SITE CONDOMINIUM P.B. SJH 245 P.No. 16 15,790 sq.ft. or 0.3625 ac.

LAND UNIT 42-A NATIONAL HARBOR PARCEL 42 SITE CONDOMINIUM P.B. MMB 240 P.No.33

PHASE SIX POTOMAC OVERLOOK CONDOMINIUM VI P.B. SJH 244 P.Nos. 26 - 31

FAIR WINDS WAY (PRIVATE ROAD)

CONDOMINIUM PLAT SHEET 2 OF 5 PHASE ONE POTOMAC OVERLOOK CONDOMINIUM VII OXON HILL (12th) ELECTION DISTRICT PRINCE GEORGE'S COUNTY, MARYLAND SCALE 1" = 10' SEPTEMBER 2016



4300 Forbes Boulevard, Suite 230 Lanham, MD 20706 P.301.794.7555 F.301.794.7656 Engineering // Surveying // Planning // Environmental Sciences www.solteszco.com

NOTES

- 1) The dimensions given for the building shown hereon were measured along the exterior wall of the foundation.
2) The driveway, and masonry porch and steps serving each Unit are part of the Unit.
3) Limited common elements are designated hereon as L.C.E.
4) General common elements are designated hereon as G.C.E.
5) Walkways, driveways, porches, and stoops are intended to be constructed in the areas shown on the approved site plan.

RECORDED 9/27/16 PLAT BOOK SJH245 PLAT NO. 66

FILED SEP 27 2016

CLERK OF THE CIRCUIT COURT FOR PRINCE GEORGE'S COUNTY, MD

P217961

MSA C2381-20041-2

S:\1006-01\plandis\SURVEY\Phase1\potomac-overlook-cond-vii\phase-01-sheet2.sht Scale= 10.0000 ft / in. User= jsaikel PLOT= Special.plt\tdwg Special.plt\tdwg Penltbl= TEXT_SUB.tbl 9/23/2016 2:13:33 PM