

SJH244 27

PRINCE GEORGE'S COUNTY CIRCUIT COURT (Subdivision Plats, PG) Plat Book SJH 244, pp. 26-31, MSA_S1250_19477. Date available 2016/02/04. Printed 02/01/2023.

N/F
NATIONAL HARBOR
WATERFRONT L.C.
L. 13822 f.256

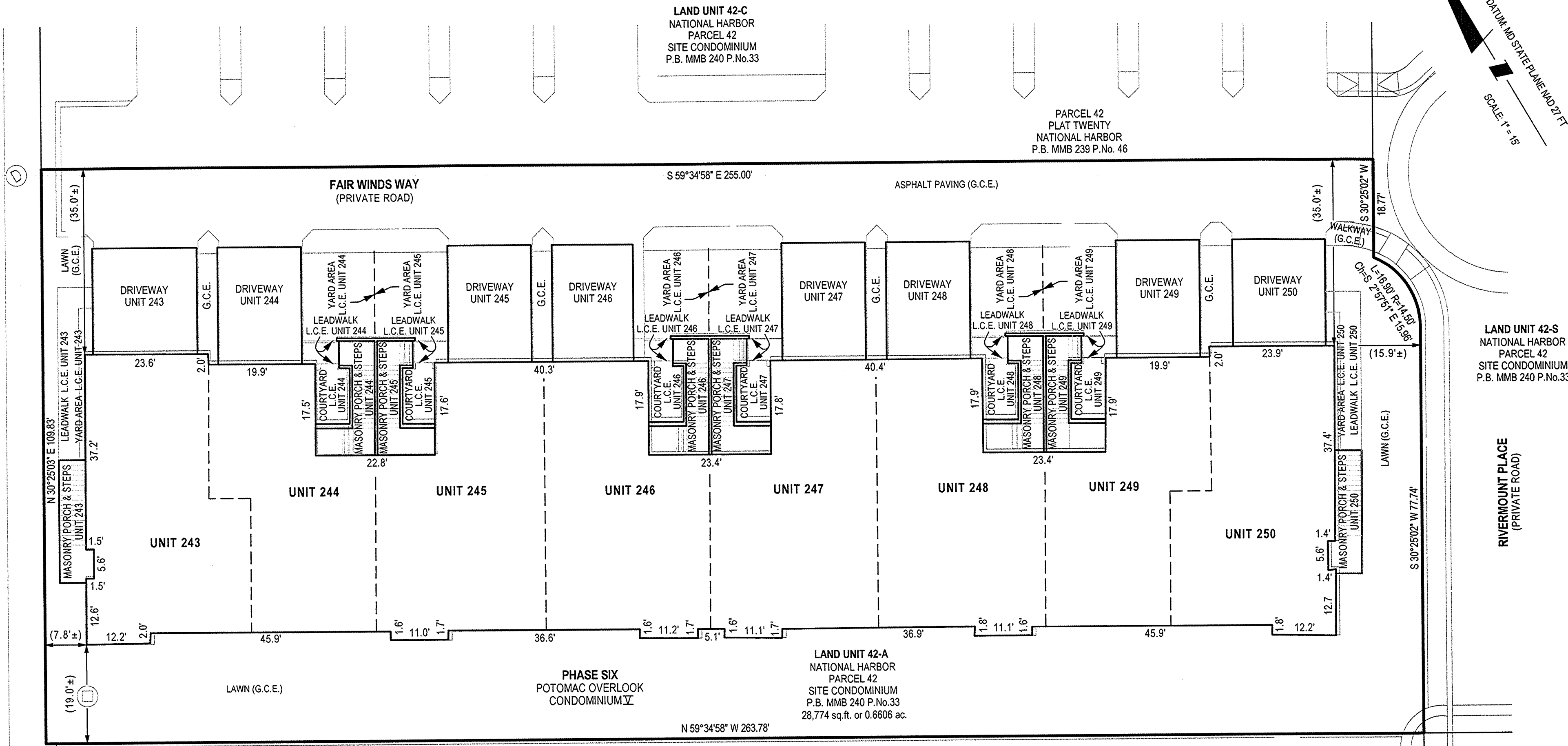

LAND UNIT 42-S
NATIONAL HARBOR
PARCEL 42
SITE CONDOMINIUM
P.B. MMB 240 P.No.33

RIVERMOUNT PLACE
(PRIVATE ROAD)

PARCEL "Q"
PLAT SEVENTEEN
PLAT OF CORRECTION
NATIONAL HARBOR
P.B. MMB 237 P.No. 91



- NOTES**
- 1) The dimensions given for the building shown hereon were measured along the exterior wall of the foundation.
 - 2) The driveway, and masonry porch and steps serving each Unit are part of the Unit.
 - 3) Limited common elements are designated hereon as L.C.E.
 - 4) General common elements are designated hereon as G.C.E.
 - 5) Walkways, driveways, porches, and stoops are intended to be constructed in the areas shown on the approved site plan.

RECORDED 214116
 PLAT BOOK SJH244
 PLAT NO. 27

FILED
 FEB 04 2016
 CLERK OF THE CIRCUIT COURT
 PRINCE GEORGE'S COUNTY, MARYLAND

CONDOMINIUM PLAT
 SHEET 2 OF 6
**PHASE SIX
 POTOMAC OVERLOOK
 CONDOMINIUM V**
 OXON HILL (12th) ELECTION DISTRICT
 PRINCE GEORGE'S COUNTY, MARYLAND
 SCALE 1" = 15' JANUARY 2016

SOLTESZ
 LANHAM OFFICE
 4300 Forbes Boulevard, Suite 230 Lanham, MD 20706 P.301.794.7555 F.301.794.7656
 Engineering Planning Environmental Sciences www.solteszco.com

214116
 SJH244 27

P23867

MSA S1250-19477-2

S:\1006-011\planets\SURVEY\Plat\potomac-overlook-condo-v\phase-06-sheet-2.sht Scale= 15.0000 ft./in. User= P\Quible PL\Tov= Grey,plctg Pemb= TEXT SUBJ= 1/8/2016 6:48:19 AM