

PARCEL 42
PLAT TWENTY
NATIONAL HARBOR
P.B. MMB 239 P.No. 46

N/F
NATIONAL HARBOR
WATERFRONT L.C.
L.13822 f.256f

PARCEL "Q"
PLAT SEVENTEEN
PLAT OF CORRECTION
NATIONAL HARBOR
P.B. MMB 237 P.No. 91

RIVERMOUNT PLACE
(PRIVATE ROAD)

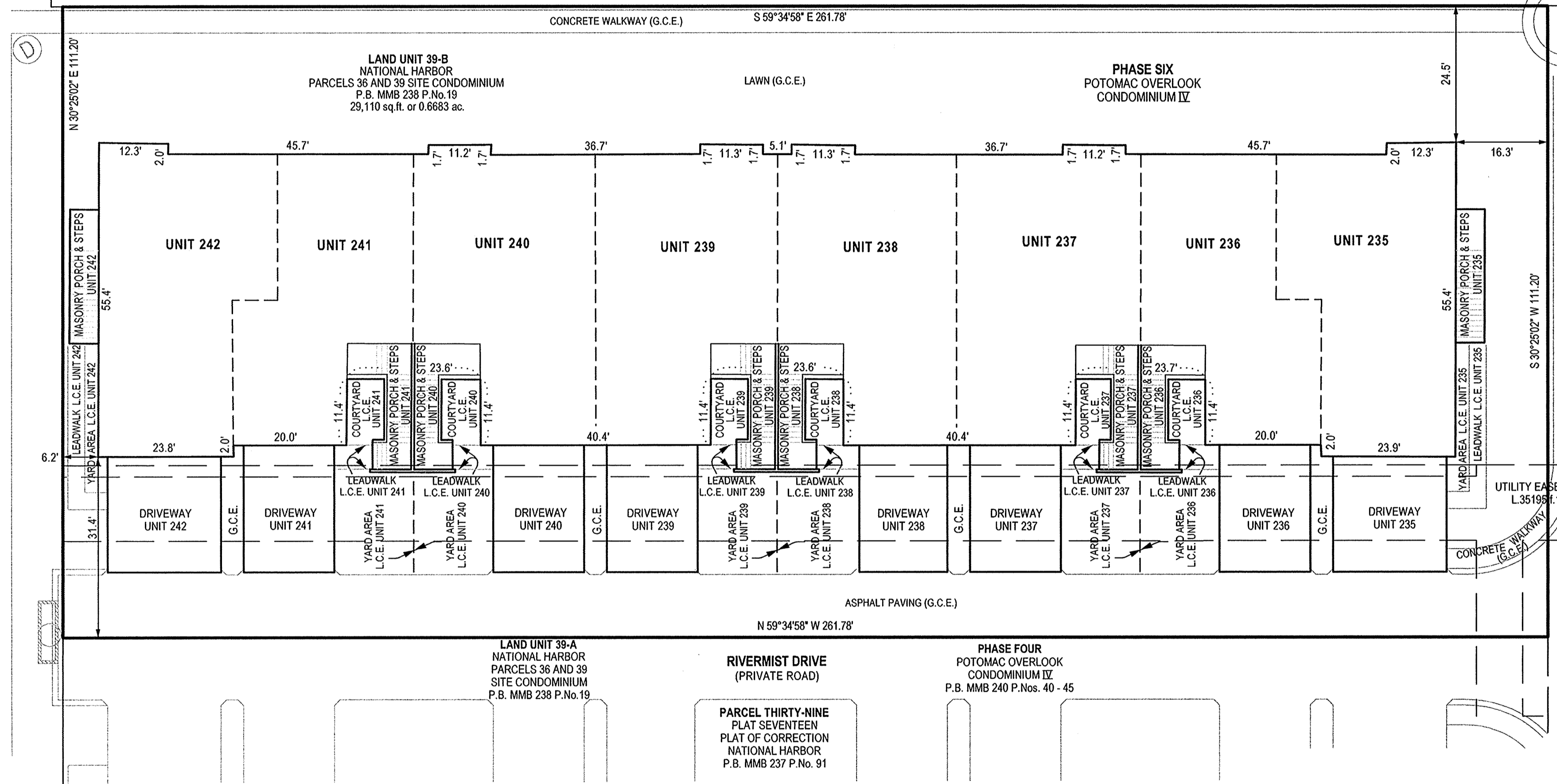

FILED
OCT 29 2014

CLERK OF THE CIRCUIT COURT
FOR PRINCE GEORGES COUNTY, MD.

NOTES

- 1) The dimensions given for the building shown hereon were measured along the exterior wall of the foundation.
- 2) The driveway, and masonry porch and steps serving each Unit are part of the Unit.
- 3) Limited common elements are designated hereon as L.C.E.
- 4) General common elements are designated hereon as G.C.E.
- 5) Walkways, driveways, porches, and stoops are intended to be constructed in the areas shown on the approved site plan.

RECORDED	10/29/14
PLAT BOOK	MMB241
PLAT NO.	53

CONDOMINIUM PLAT
SHEET 2 OF 6
**PHASE SIX
POTOMAC OVERLOOK
CONDOMINIUM IV**

OXON HILL (12th) ELECTION DISTRICT
PRINCE GEORGE'S COUNTY, MARYLAND
SCALE 1" = 15' JULY 2014



LANHAM OFFICE
4300 Forbes Boulevard, Suite 230 Lanham, MD 20706 P.301.794.7555 F.301.794.7656
Engineering Planning Environmental Sciences www.solteszco.com

S:\1006-011\upland\SURVEY\Plats\potomac-overlook-condo-iv\phase-06-sheet-2.shx Scale= 15.0000 ft / in. User= P\Quibbe PLT\dn= Grey.plt\cplg Pentable TEXT SUBJ.tbl 10/27/2014 7:10:10 AM

P.207104 MGA C2381-19771-2