

MMB 240-41

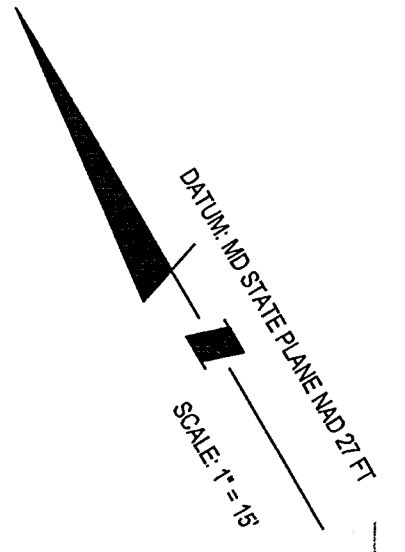

N/F NATIONAL HARBOR WATERFRONT L.C. L.13822 f.256

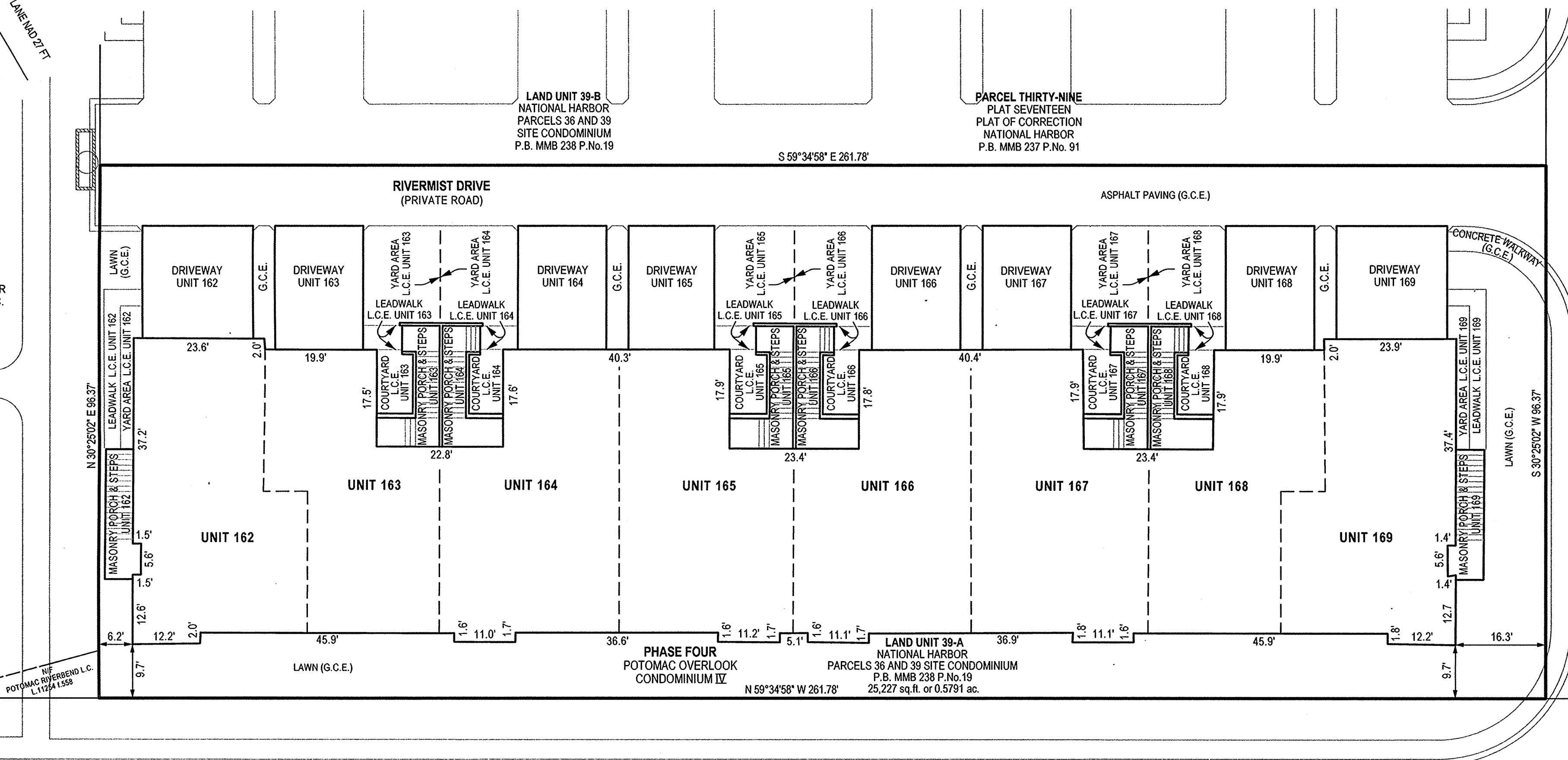

PARCEL "Q"  
PLAT SEVENTEEN  
PLAT OF CORRECTION  
NATIONAL HARBOR  
P.B. MMB 237 P.No. 91

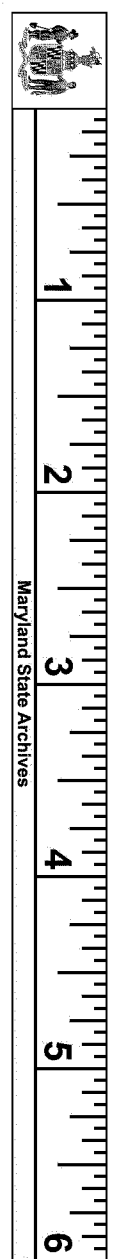

8/10/14

S:\11005-01\plans\SURVEY\Plats\potomac-overlook-condo-IV\phase-04-sheet-2.sht Scale= 15,000 ft / in. User= jsaukel PLT.Dwg= Special.plt\big Penib= TEXT\_SUB.tbl/4/17/2014 10:54:23 AM

PARCEL "N"  
PLAT OF CORRECTION  
PLAT THIRTEEN  
NATIONAL HARBOR  
P.B. MMB 234 P.No. 22

WATERFRONT STREET  
(PRIVATE ROAD)

**FILED**

APR 23 2014

CLERK OF THE CIRCUIT COURT  
FOR PRINCE GEORGES COUNTY, MD.

**NOTES**

- 1) The dimensions given for the building shown hereon were measured along the exterior wall of the foundation.
- 2) The driveway, and masonry porch and steps serving each Unit are part of the Unit.
- 3) Limited common elements are designated hereon as L.C.E.
- 4) General common elements are designated hereon as G.C.E.
- 5) Walkways, driveways, porches, and stoops are intended to be constructed in the areas shown on the approved site plan.

CONDOMINIUM PLAT  
SHEET 2 OF 6  
**PHASE FOUR  
POTOMAC OVERLOOK  
CONDOMINIUM IV**  
OXON HILL (12th) ELECTION DISTRICT  
PRINCE GEORGE'S COUNTY, MARYLAND  
SCALE 1" = 15' APRIL 2014



LANHAM OFFICE  
4300 Forbes Boulevard, Suite 230 Lanham, MD 20706 P.301.794.7555 F.301.794.7656  
Engineering Planning Environmental Sciences www.solteszco.com

RECORDED 4/24/14  
PLAT BOOK MMB 240  
PLAT NO. 41

P.204258 MSA S1250-19208-2