

PHASE THREE
POTOMAC OVERLOOK
CONDOMINIUM III
P.B. MMB 238 P.Nos. 8 - 12

LAND UNIT 35-C
NATIONAL HARBOR
PARCEL 35
SITE CONDOMINIUM
P.B. MMB 236 P.No.75

LAND UNIT 35-E
NATIONAL HARBOR
PARCEL 35
SITE CONDOMINIUM
P.B. MMB 236 P.No.75

S59°34'58"E 184.76'
SENTRY SQUARE
(PRIVATE ROAD)

LAND UNIT 35-D
NATIONAL HARBOR
PARCEL 35
SITE CONDOMINIUM
P.B. MMB 236 P.No.75
19,430 sq.ft. or 0.4460 ac.

LAND UNIT 35-F
NATIONAL HARBOR
PARCEL 35
SITE CONDOMINIUM
P.B. MMB 236 P.No.75

PHASE TWO
POTOMAC OVERLOOK
CONDOMINIUM III
P.B. MMB 237 P.Nos. 94 - 97

LAND UNIT 35-B
NATIONAL HARBOR
PARCEL 35
SITE CONDOMINIUM
P.B. MMB 236 P.No.75

LAND UNIT 35-G
NATIONAL HARBOR
PARCEL 35
SITE CONDOMINIUM
P.B. MMB 236 P.No.75

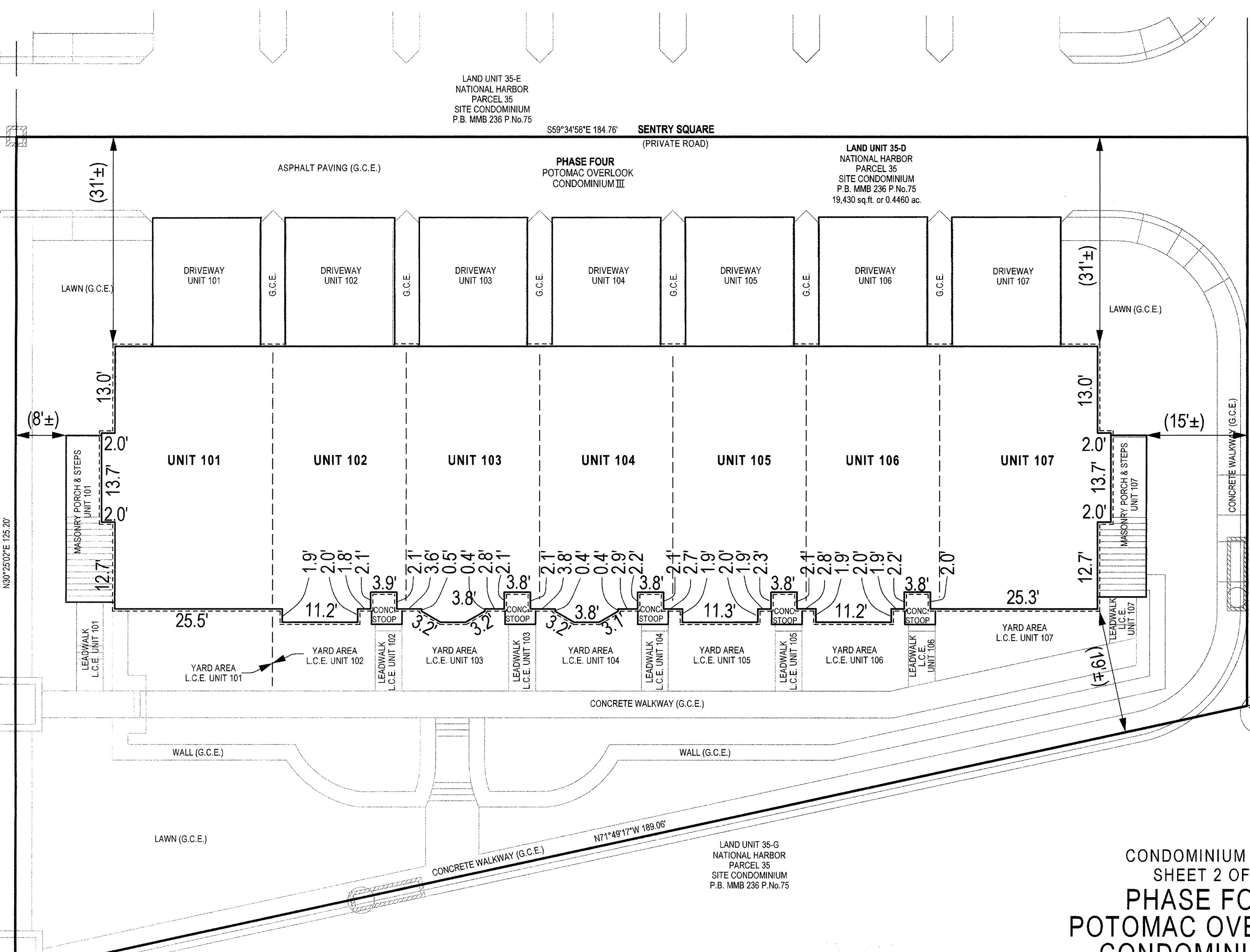

NOTES

- 1) The dimensions given for the building shown hereon were measured along the exterior wall of the foundation.
- 2) The driveway and concrete stoop or masonry porch serving each Unit is part of the Unit.
- 3) Limited common elements are designated hereon as L.C.E.
- 4) General common elements are designated hereon as G.C.E.
- 5) Walkways, driveways, porches, and stoops are intended to be constructed in the areas shown on the approved site plan.

FILED

JUN 25 2013

CLERK OF THE CIRCUIT COURT
FOR PRINCE GEORGES COUNTY, MD.

CONDOMINIUM PLAT
SHEET 2 OF 5
PHASE FOUR
POTOMAC OVERLOOK
CONDOMINIUM III

OXON HILL (12th) ELECTION DISTRICT
PRINCE GEORGES COUNTY, MARYLAND
SCALE 1" = 10' JUNE 2013



SOLTESZ

LANHAM OFFICE

4300 Forbes Boulevard, Suite 230 Lanham, MD 20706 P.301.794.7555 F.301.794.7656

Engineering Planning Environmental Sciences

www.solteszco.com

RECORDED	6-25-13
PLAT BOOK	MMB 238
PLAT NO.	52

P200139 MSA SSU 1250 14047-2

PRINCE GEORGES COUNTY CIRCUIT COURT (Subdivision Plats, PG) Plat Book MMB 238, pp. 51-57 MSA 1250 69047. Date Available 2013/06/25 Printed 06/20/2013.

S:\1006-01\Udlands\SURVEY\Plats\potomac-overlook-condo-III\phase-04-sheet-2.sht Scale=10,0000 ft./in. User=PQ\jble PLTrdv=Color.plt Penib=TEXT SUB.tbl 6/24/2013 2:44:56 PM